

PROFILI SERIE "K" DISSIPATORI A "PETTINE"

"COMB" PROFILES SERIES "K"

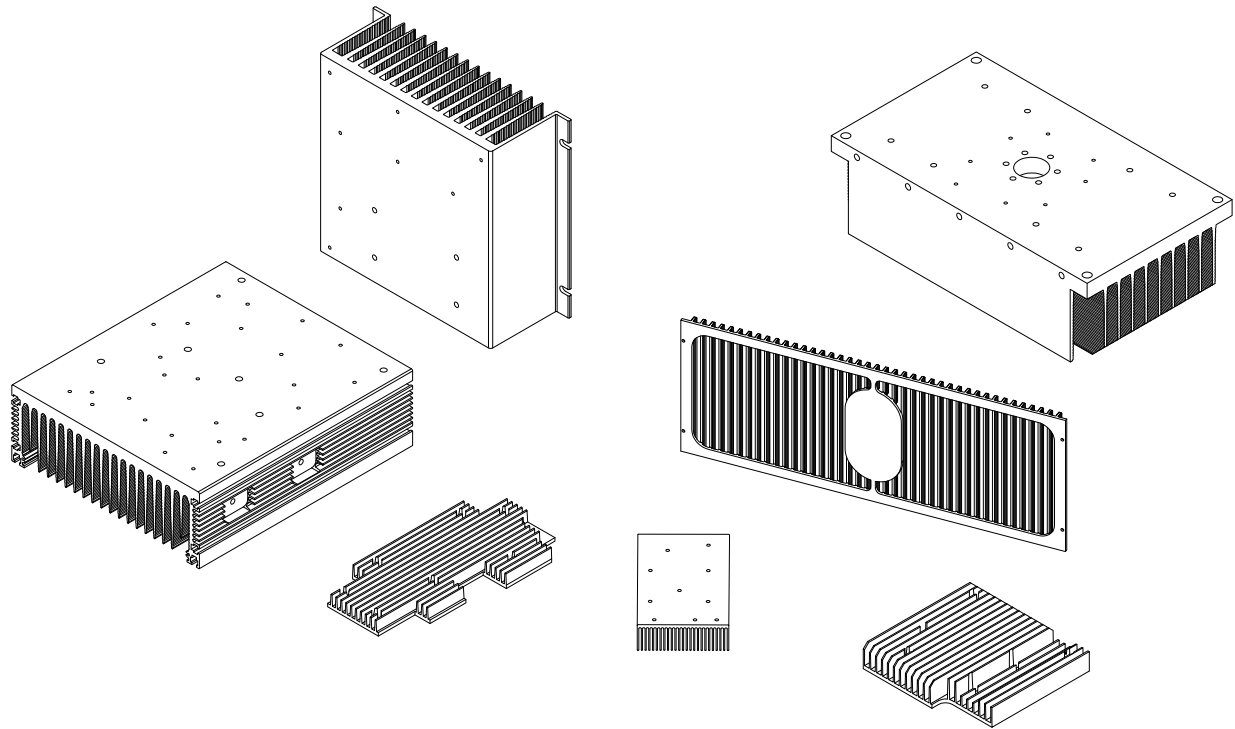

Le attuali esigenze di dissipazione hanno indotto i progettisti più "tradizionalisti", ad orientarsi su profili aventi dimensioni sempre maggiori, dal momento che con l' estrusione esistono limiti dimensionali.

Tecnoal ha introdotto nel proprio catalogo una vasta gamma di profili di grandi dimensioni ottenuti mediante saldatura.

Recentemente, al fine di ridurre i costi, i tempi produttivi e di garantire il processo di lavorazione è stata inserita una nuova linea di saldatura completamente automatica e computerizzata.

I profili saldati risultano avere caratteristiche meccaniche ed estetiche simili ai profili integrali. In caso di ossidazione anodica la zona saldata avrà una tonalità cromatica leggermente diversa dal resto del pezzo.

Tecnoal è in grado di eseguire anche su tali pezzi tutte le lavorazioni meccaniche, così come sui profili integrali.

Si possono altresì creare dei nuovi profili rispondenti a specifiche esigenze del cliente, qualora i quantitativi lo consentano.

I profili specificati nel presente catalogo sono gestiti a magazzino in barre di lunghezza compresa tra i 3 e i 5m a seconda dei modelli e del relativo peso al metro lineare.

Tecnoal è in grado di fornire il particolare comprensivo di tutte le lavorazioni e di eventuali trattamenti superficiali.

Qualora voleste richiederci una qualsiasi quotazione vi preghiamo di fornirci le seguenti informazioni:

- 1 - Profilo e relativa lunghezza di taglio (Esempio: K500/400 - viene così indicato il profilo K500 tagliato a 400mm).
- 2 - Quantitativo del lotto di produzione
- 3 - Eventuali lavorazioni meccaniche da eseguire, meglio se corredate da un file contenente un disegno tecnico nei formati pdf, dwg, dxf. Questi ultimi due possono essere importati direttamente nel nostro sistema CAD-CAM consentendo una tempistica più breve. Vi invitiamo a fornire sempre disegni dove le quote non siano state forzate.
- 4 - Specificare eventuali trattamenti superficiali, quali anodizzazione (indicare il colore), alodine, ecc....

Il nostro ufficio commerciale e tecnico è a Vostra completa disposizione per qualsiasi chiarimento.

The current dissipation requirements focus more traditional designers on profiles with increasing size as with extrusion there are dimensional limits.

Tecnoal has introduced in its catalogue a wide range of large welded profiles.

Recently, in order to reduce costs, production lead time and to grant the quality of the manufacturing process, it was started a new welding line completely automatic and computerized.

The welded profiles have mechanical and aesthetic features similar to the full profiles. In case of anodic oxidation welded area will have a slightly different tone color from the rest of the piece.

Tecnoal is able to make on these pieces all machining as well as on full profiles.

New profiles can be designed to meet specific customers request depending on quantities requested.

All profiles of this series are stored in bars with length between 3 and 5 meters depending to the model and relative linear weight.

Tecnoal is able to provide this series including all machining and any surface treatments.

For quotations please provide the following informations:

- 1 - Profile and relevant length (Example: K500/400 - Specifies the profile K500 cut to 400mm).
- 2 - Quantity of batch production.
- 3 - Any machining, to perform better if accompanied by a file containing a technical drawing in pdf, dwg, dxf format. Dwg and dxf formats can be imported directly into our system CAD-CAM allowing a shorter time. Please provide drawing always where dimensions have not been forced.
- 4 - Specify any surface treatments such anodization including color, alodine, etc...

Our commercial and technical office is at your disposal for any clarification.



K19

Peso Kg/m
Weight Kg/m

0.15

Rt °C/W 9

Lung. campione mm
Sample length mm 50

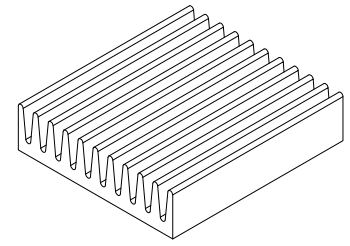
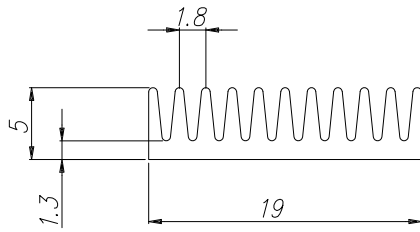

A

TECNOAL
BOLOGNA - ITALY

K30

Peso Kg/m
Weight Kg/m

1.04

Rt °C/W 4.8

Lung. campione mm
Sample length mm 100

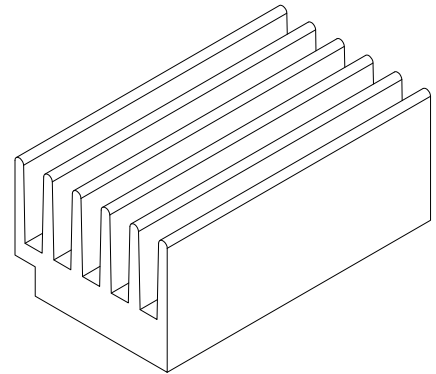
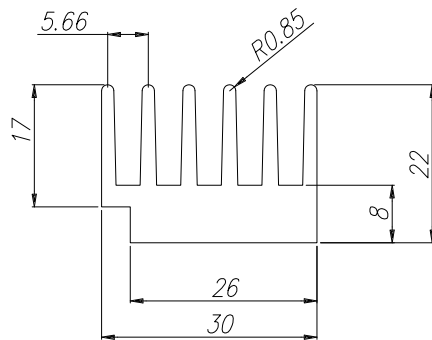

B

TECNOAL
BOLOGNA - ITALY

K34

Peso Kg/m
Weight Kg/m

2.85

Rt °C/W

1.65

Lung. campione mm
Sample length mm

100

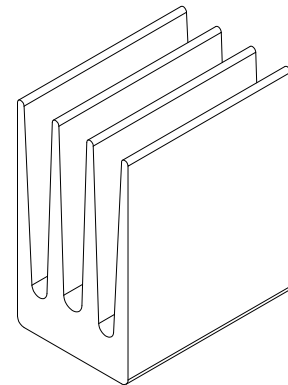
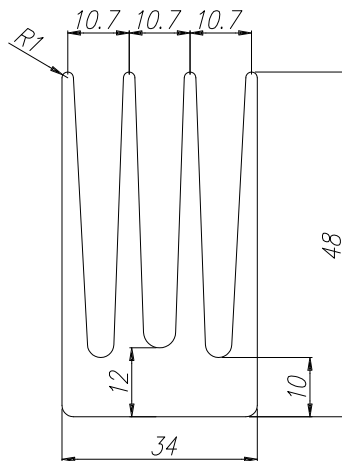

C

TECNOAL
BOLOGNA - ITALY

K40

Peso Kg/m
Weight Kg/m

1.53

Rt °C/W

3.9

Lung. campione mm
Sample length mm

100

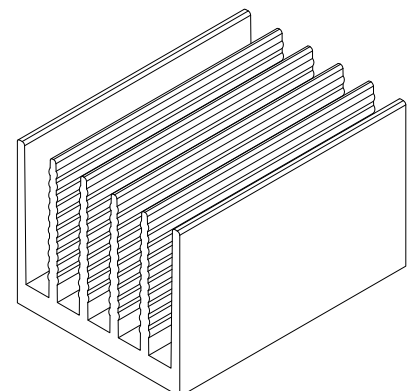
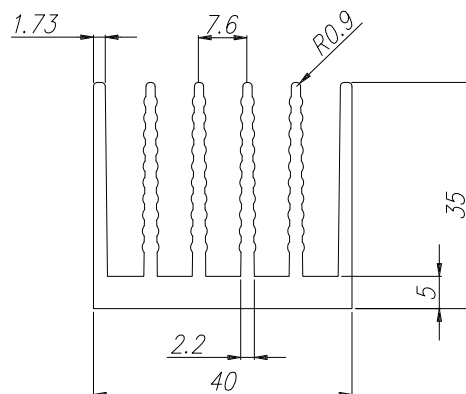

D

TECNOAL
BOLOGNA - ITALY



A

K42

Peso Kg/m
Weight Kg/m

0.95

Rt °C/W

4.2

Lung. campione mm
Sample length mm

100

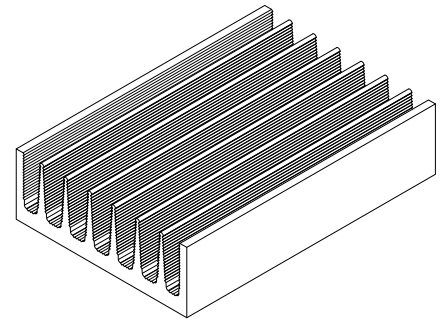
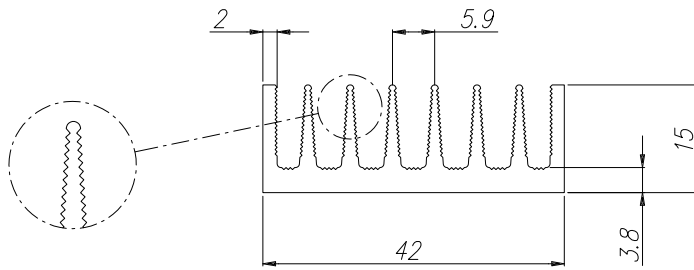

TECNOAL
BOLOGNA - ITALY

B

K48

Peso Kg/m
Weight Kg/m

2.00

Rt °C/W

2.1

Lung. campione mm
Sample length mm

100

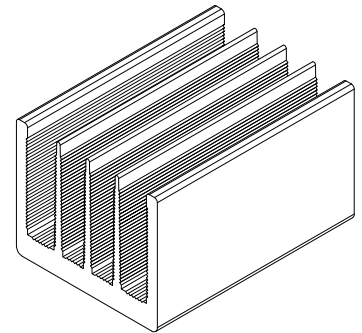
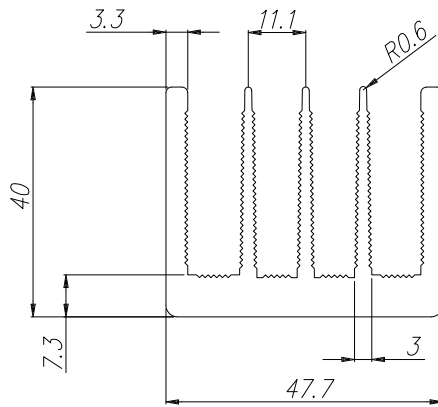

TECNOAL
BOLOGNA - ITALY

C

K52

Peso Kg/m
Weight Kg/m

2.50

Rt °C/W

2.0

Lung. campione mm
Sample length mm

100

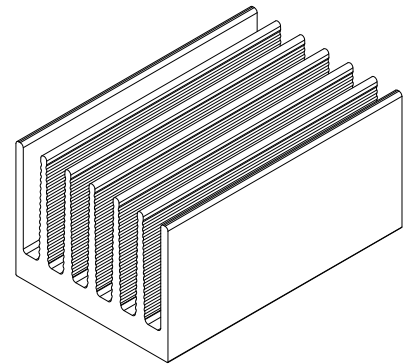
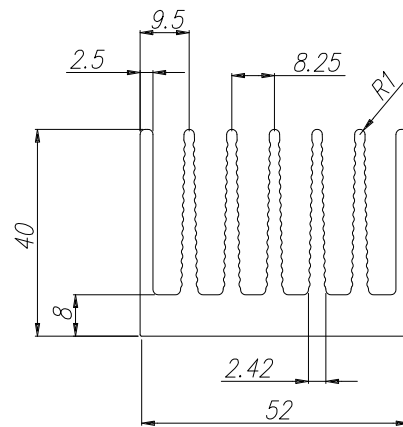

TECNOAL
BOLOGNA - ITALY

D

K56

Peso Kg/m
Weight Kg/m

3.90

Rt °C/W

1.6

Lung. campione mm
Sample length mm

100

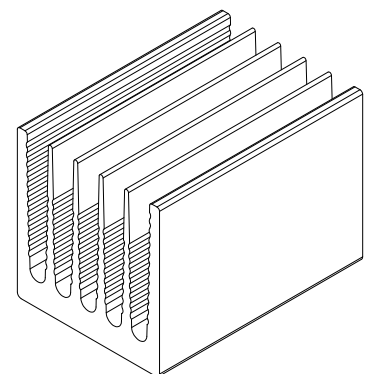
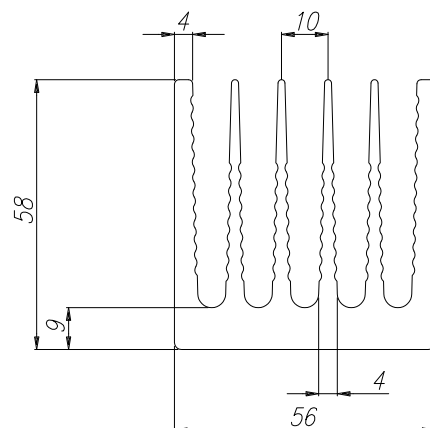

TECNOAL
BOLOGNA - ITALY



K65	
Peso Kg/m Weight Kg/m	1.70
Rt °C/W	2.7
Lung. campione mm Sample length mm	100

A

TECNODAL
BOLOGNA - ITALY

K66B	
Peso Kg/m Weight Kg/m	3.30
Rt °C/W	1.65
Lung. campione mm Sample length mm	100

B

TECNODAL
BOLOGNA - ITALY

KA66	
Peso Kg/m Weight Kg/m	5.10
Rt °C/W	1.59
Lung. campione mm Sample length mm	100

C

Ventilazione forzata Forced ventilation	Rt °C/W	0.22	Velocità dell'aria in uscita (m/sec) Outgoing air speed (m/sec)	3.0	Lung. campione mm Sample length mm	100
--	---------	------	--	-----	---------------------------------------	-----

TECNODAL
BOLOGNA - ITALY

K72	
Peso Kg/m Weight Kg/m	3.10
Rt °C/W	2.30
Lung. campione mm Sample length mm	100

D

Ventilazione forzata Forced ventilation	Rt °C/W	0.32	Velocità dell'aria in uscita (m/sec) Outgoing air speed (m/sec)	3.0	Lung. campione mm Sample length mm	100
--	---------	------	--	-----	---------------------------------------	-----

TECNODAL
BOLOGNA - ITALY

A

K76	
Peso Kg/m Weight Kg/m	2.30
Rt °C/W	1.75
Lung. campione mm Sample length mm	150

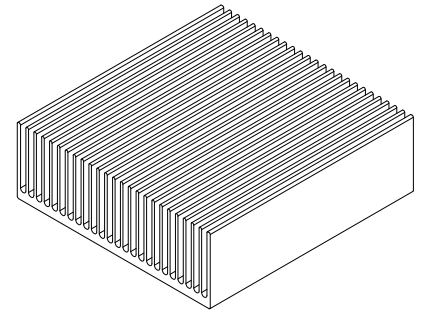
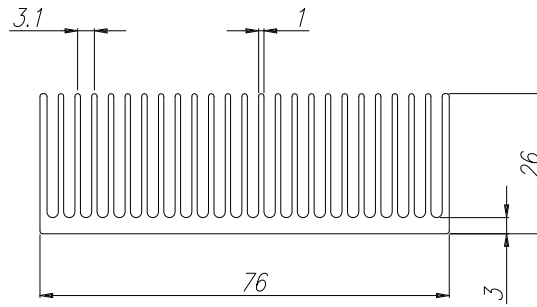

Ventilazione forzata Forced ventilation	Rt °C/W	0.21	Velocità dell'aria in uscita (m/sec) Outgoing air speed (m/sec)	3.0	Lung. campione mm Sample length mm	150
--	---------	------	--	-----	---------------------------------------	-----



KE82	
Peso Kg/m Weight Kg/m	2.74
Rt °C/W	1.60
Lung. campione mm Sample length mm	100

B

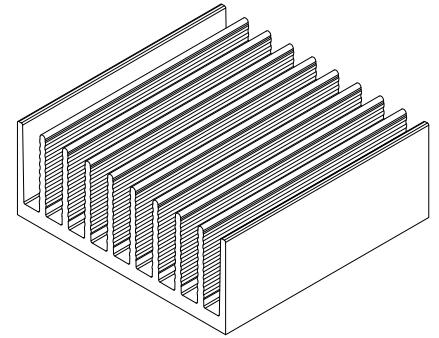
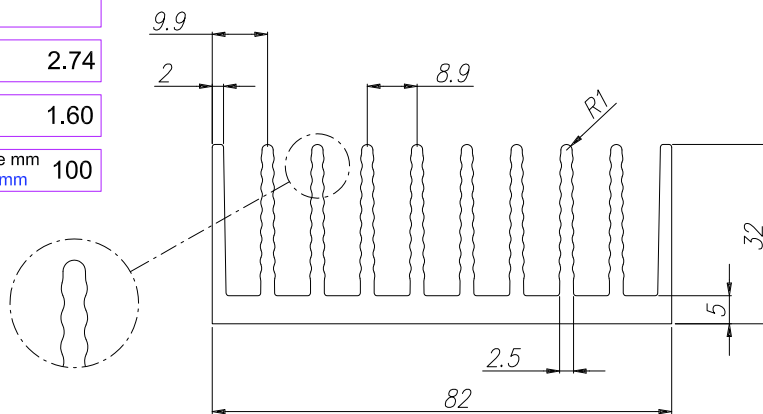

KEA82	
Peso Kg/m Weight Kg/m	5.00
Rt °C/W	1.10
Lung. campione mm Sample length mm	100

C

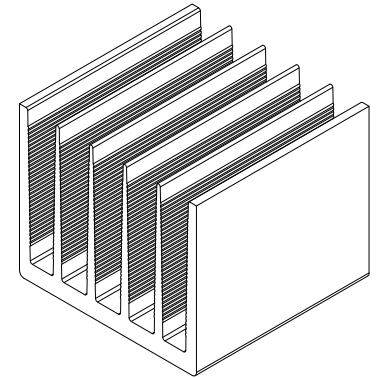
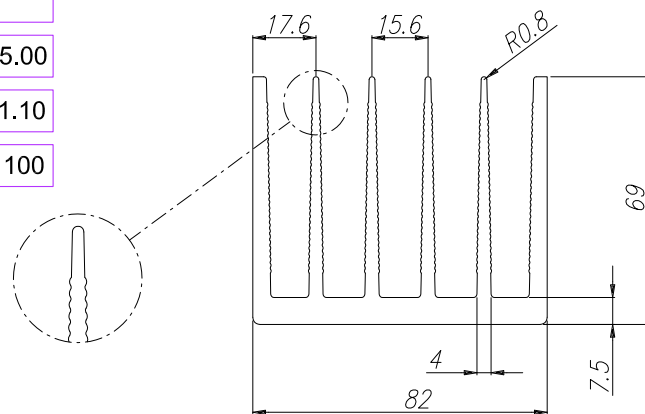

K91	Peso Kg/m Weight Kg/m	1.07	Rt °C/W	3.35	Lung. campione mm Sample length mm	100
------------	--------------------------	------	---------	------	---------------------------------------	-----

D

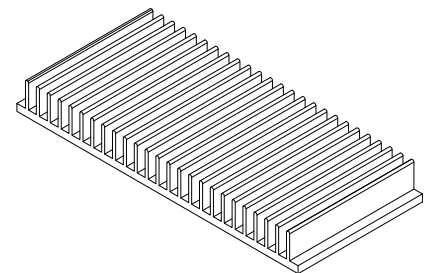
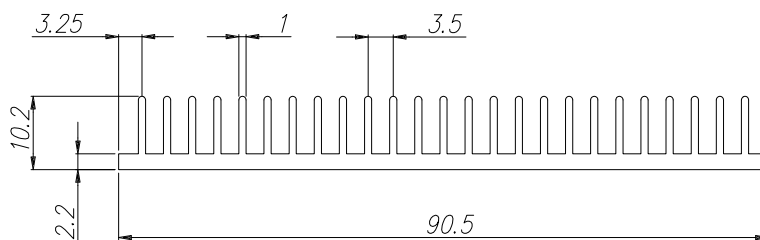

Ventilazione forzata Forced ventilation	Rt °C/W	0.325	Velocità dell'aria in uscita (m/sec) Outgoing air speed (m/sec)	3.0	Lung. campione mm Sample length mm	100
--	---------	-------	--	-----	---------------------------------------	-----





K92

Peso Kg/m **5.58**
Weight Kg/m

Rt °C/W **1.16**

Lung. campione mm **100**
Sample length mm

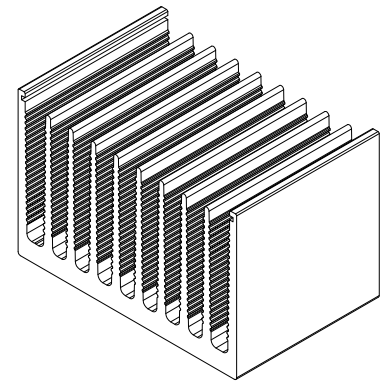
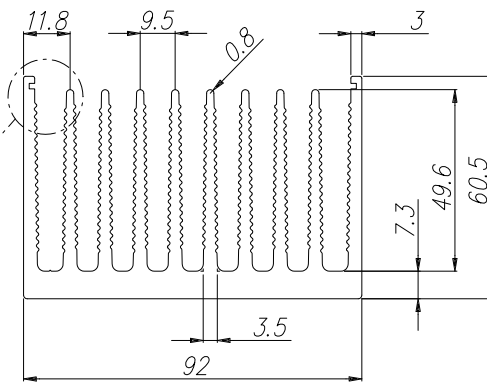
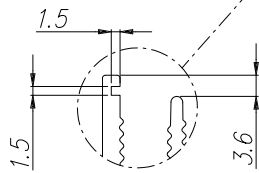

A

Ventilazione forzata
Forced ventilation

Rt °C/W **0.160**

Velocità dell'aria in uscita (m/sec)
Outgoing air speed (m/sec) **5.0**

Lung. campione mm **100**
Sample length mm

TECNOAL
BOLOGNA - ITALY

K100

Peso Kg/m **4.70**
Weight Kg/m

Rt °C/W **1.10**

Lung. campione mm **100**
Sample length mm

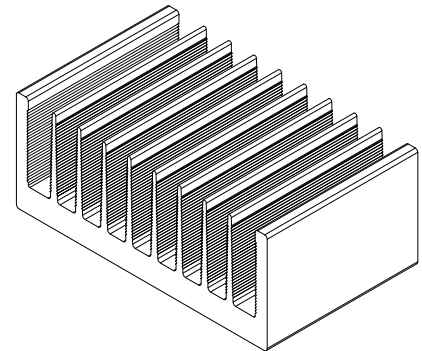
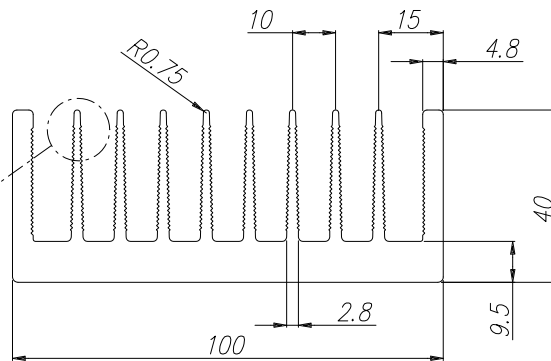
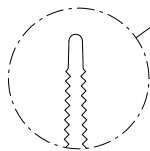

B

TECNOAL
BOLOGNA - ITALY

K100A

Peso Kg/m **4.20**
Weight Kg/m

Rt °C/W **1.15**

Lung. campione mm **100**
Sample length mm

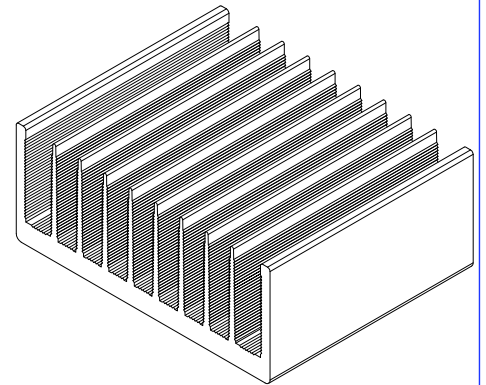
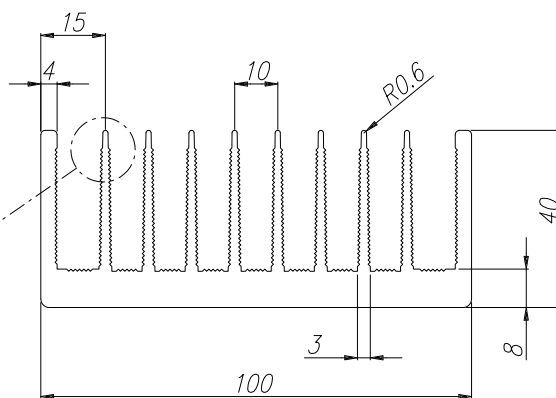
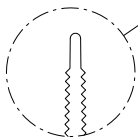

C

TECNOAL
BOLOGNA - ITALY

KE100

Peso Kg/m **2.15**
Weight Kg/m

Rt °C/W **3.0**

Lung. campione mm **100**
Sample length mm

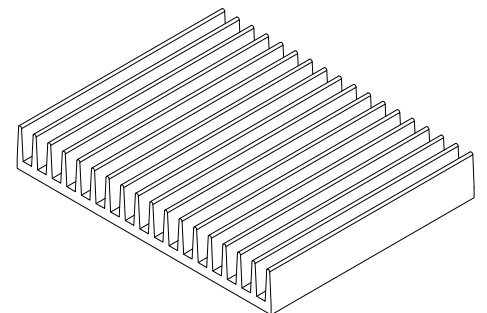
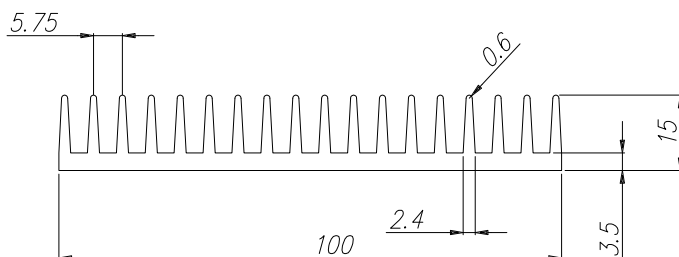

D

TECNOAL
BOLOGNA - ITALY



A

K112	
Peso Kg/m Weight Kg/m	8.70
Rt °C/W	0.90
Lung. campione mm Sample length mm	100

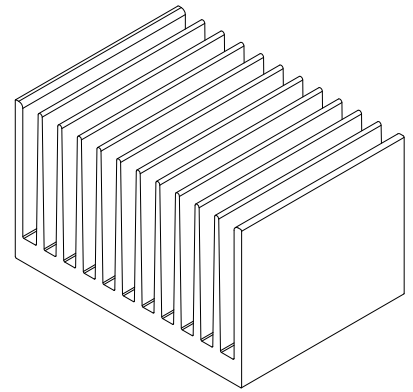
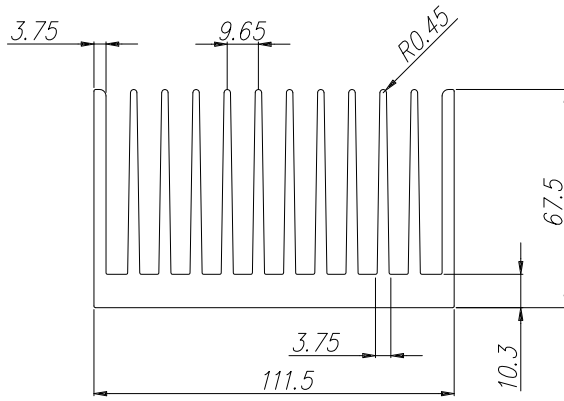

TECNODAL
BOLOGNA - ITALY

B

K113	Peso Kg/m Weight Kg/m	3.40	Rt °C/W	1.30	Lung. campione mm Sample length mm	100
-------------	--------------------------	------	---------	------	---------------------------------------	-----

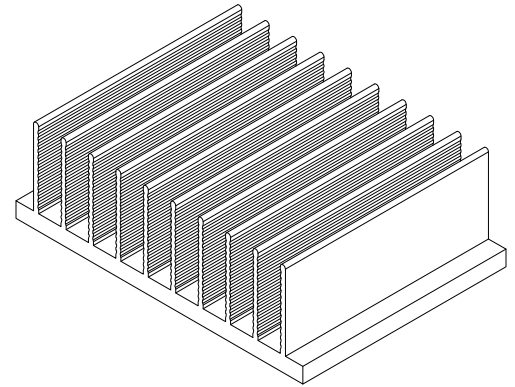
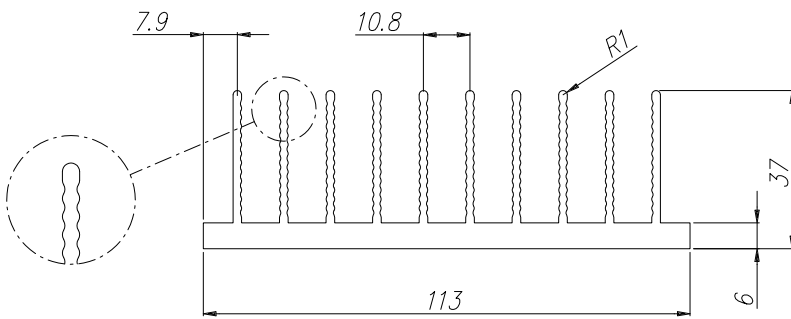

TECNODAL
BOLOGNA - ITALY

C

K120	
Peso Kg/m Weight Kg/m	8.10
Rt °C/W	0.82
Lung. campione mm Sample length mm	100

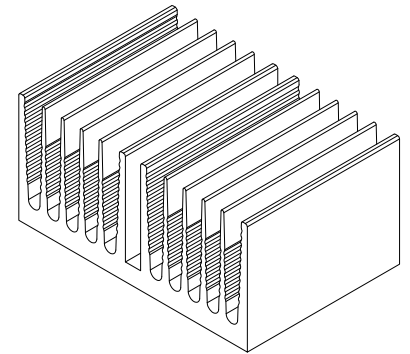
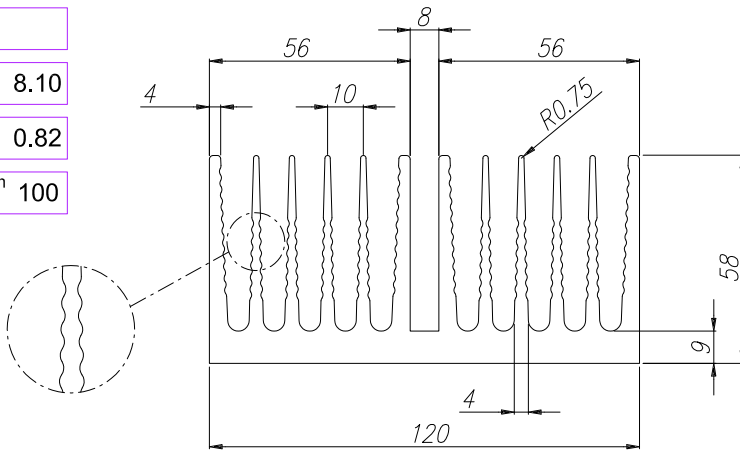

TECNODAL
BOLOGNA - ITALY

D

KA120	Peso Kg/m Weight Kg/m	6.00	Rt °C/W	0.88	Lung. campione mm Sample length mm	100
--------------	--------------------------	------	---------	------	---------------------------------------	-----

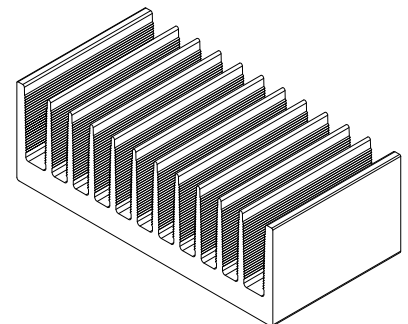
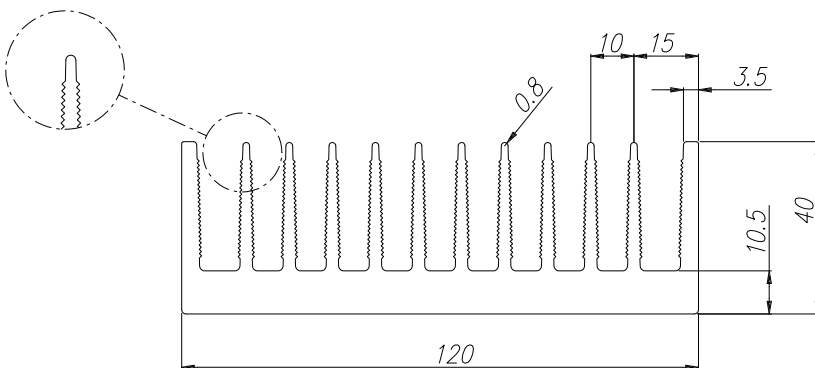

TECNODAL
BOLOGNA - ITALY



KF126	Peso Kg/m Weight Kg/m	4.38	Rt °C/W	0.5	Lung. campione mm Sample length mm	100
--------------	--------------------------	-------------	---------	------------	---------------------------------------	------------

Ventilazione forzata Forced ventilation	Rt °C/W	0.147	Velocità dell'aria in uscita (m/sec) Outgoing air speed (m/sec)	5.0	Lung. campione mm Sample length mm	100
--	---------	--------------	--	------------	---------------------------------------	------------

A

K127	Peso Kg/m Weight Kg/m	4.60	Rt °C/W	1.1	Lung. campione mm Sample length mm	100
-------------	--------------------------	-------------	---------	------------	---------------------------------------	------------

B

K133	Peso Kg/m Weight Kg/m	7.53	Rt °C/W	0.78	Lung. campione mm Sample length mm	100
-------------	--------------------------	-------------	---------	-------------	---------------------------------------	------------

C

K134	Peso Kg/m Weight Kg/m	2.40	Rt °C/W	1.20	Lung. campione mm Sample length mm	150
-------------	--------------------------	-------------	---------	-------------	---------------------------------------	------------

D



K135 **Peso Kg/m** **3.10** **Rt °C/W** **1.15** **Lung. campione mm** **150**
Weight Kg/m **Sample length mm**

A

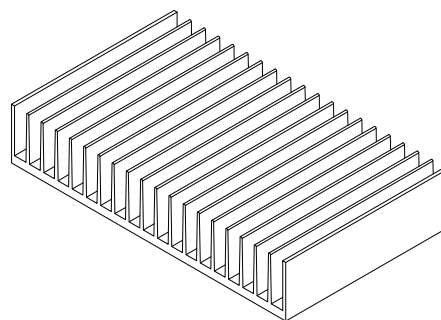
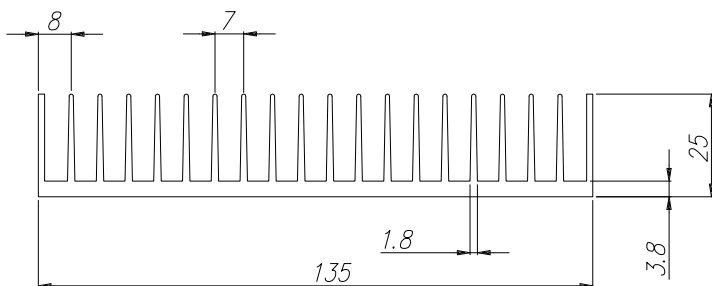

TECNOAL
BOLOGNA - ITALY

K138 **Peso Kg/m** **9.60** **Rt °C/W** **0.80** **Lung. campione mm** **200**
Weight Kg/m **Sample length mm**

B

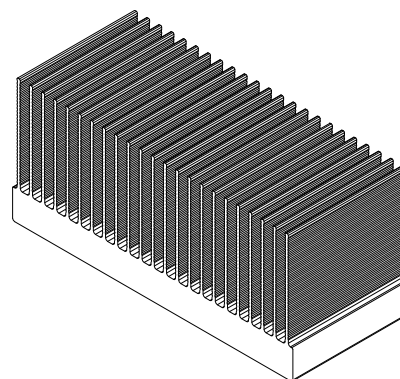
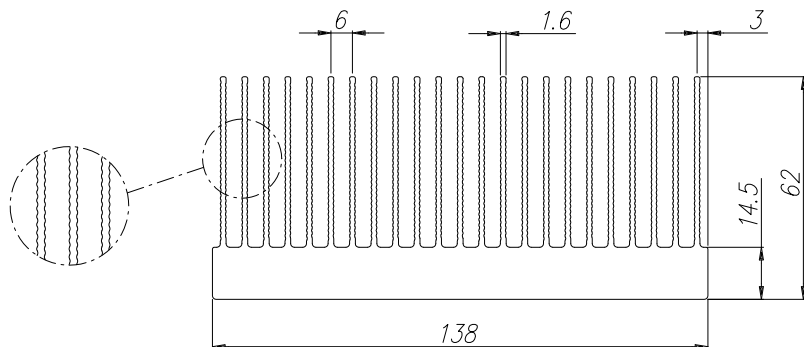

Ventilazione forzata **Rt °C/W** **0.079** **Velocità dell'aria in uscita (m/sec)** **5.0** **Lung. campione mm** **200**
Forced ventilation **Outgoing air speed (m/sec)** **Sample length mm**

TECNOAL
BOLOGNA - ITALY

KXC140

Peso Kg/m **1.95**
Weight Kg/m

C

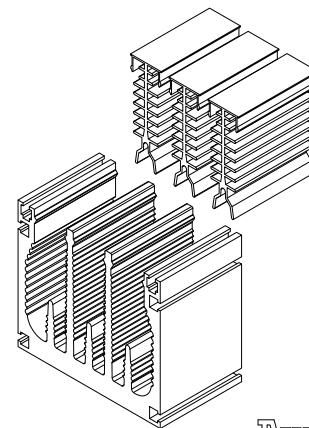
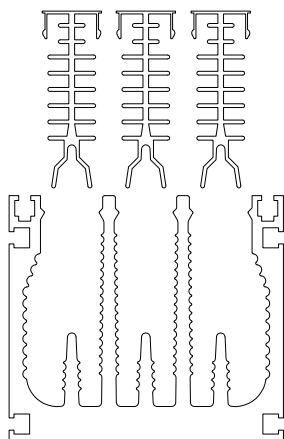

TECNOAL
BOLOGNA - ITALY

KX140

Peso Kg/m **17.85**
Weight Kg/m

KXH140

Peso Kg/m **23.7**
Weight Kg/m

Rt °C/W **0.30**

Lung. campione mm **200**
Sample length mm

D

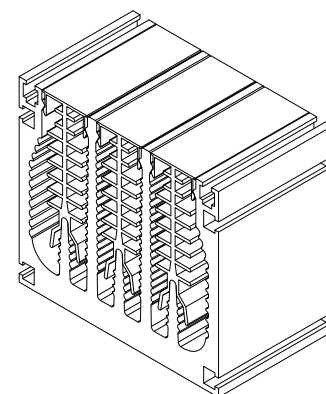
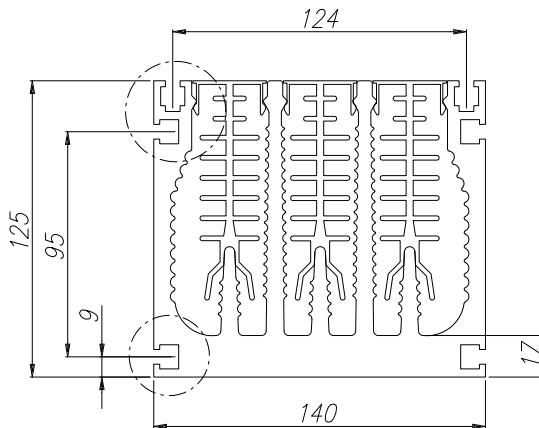
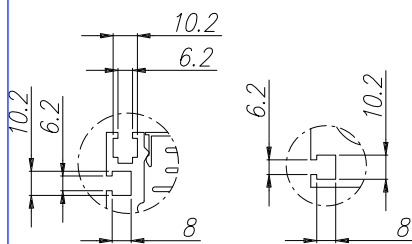

TECNOAL
BOLOGNA - ITALY



K150	Peso Kg/m Weight Kg/m	4.90	Rt °C/W	0.90	Lung. campione mm Sample length mm	150
-------------	--------------------------	-------------	---------	-------------	---------------------------------------	------------

A

TECNOAL
BOLOGNA - ITALY

I 150	Peso Kg/m Weight Kg/m	10.5	Rt °C/W	0.56	Lung. campione mm Sample length mm	200
--------------	--------------------------	-------------	---------	-------------	---------------------------------------	------------

Ventilazione forzata Forced ventilation	Rt °C/W	0.075	Velocità dell'aria in uscita (m/sec) Outgoing air speed (m/sec)	5.0	Lung. campione mm Sample length mm	200
--	---------	--------------	--	------------	---------------------------------------	------------

B

TECNOAL
BOLOGNA - ITALY

KE150	Peso Kg/m Weight Kg/m	6.50	Rt °C/W	0.62	Lung. campione mm Sample length mm	150
--------------	--------------------------	-------------	---------	-------------	---------------------------------------	------------

C

TECNOAL
BOLOGNA - ITALY

KE150A	Peso Kg/m Weight Kg/m	7.42	Rt °C/W	0.62	Lung. campione mm Sample length mm	150
---------------	--------------------------	-------------	---------	-------------	---------------------------------------	------------

D

TECNOAL
BOLOGNA - ITALY



KK150	Peso Kg/m	5.30	Rt °C/W	0.90	Lung. campione mm	150
	Weight Kg/m		Sample length mm			

TECNODAL
BOLOGNA - ITALY

KXC140	Peso Kg/m	1.95
	Weight Kg/m	

KX150	Peso Kg/m	18.20
	Weight Kg/m	

TECNODAL
BOLOGNA - ITALY

KXH150	Peso Kg/m	24.1
	Weight Kg/m	
	Rt °C/W	0.29
	Lung. campione mm	
Sample length mm		

TECNODAL
BOLOGNA - ITALY

KEAC150	Peso Kg/m	3.20
	Weight Kg/m	

KEA150	Peso Kg/m	12.60
	Weight Kg/m	

TECNODAL
BOLOGNA - ITALY



KEAH150

Peso Kg/m **15.28**
Weight Kg/m

Rt °C/W **0.70**

Lung. campione mm **100**
Sample length mm

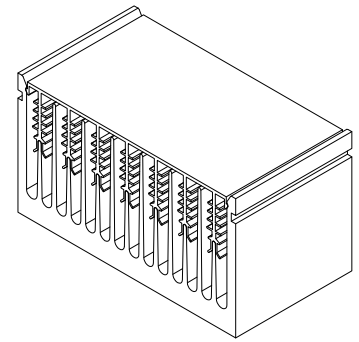
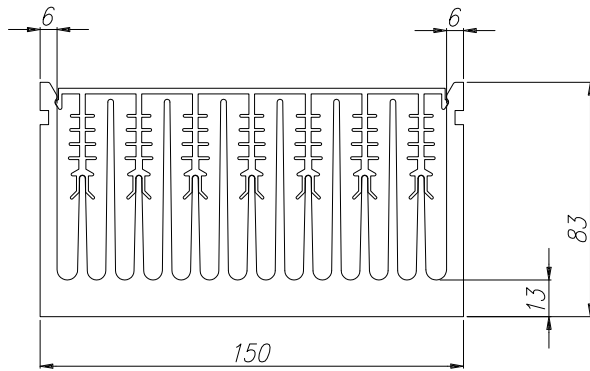

A

TECNODAL
BOLOGNA - ITALY

K158

Peso Kg/m **3.20**
Weight Kg/m

Rt °C/W **1.0**

Lung. campione mm **150**
Sample length mm

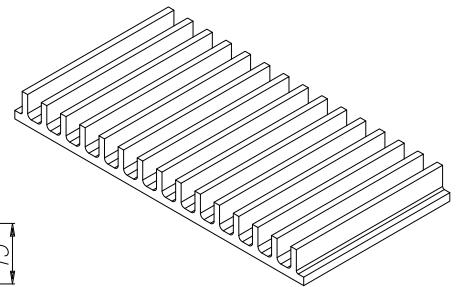
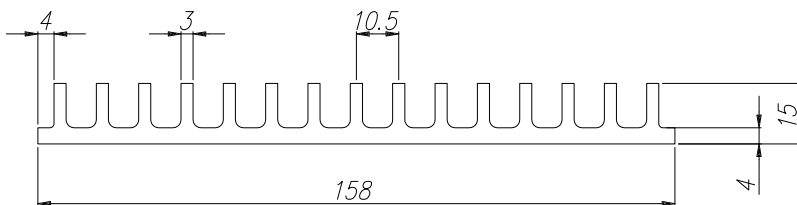

B

TECNODAL
BOLOGNA - ITALY

K160

Peso Kg/m **7.23**
Weight Kg/m

Rt °C/W **0.55**

Lung. campione mm **150**
Sample length mm

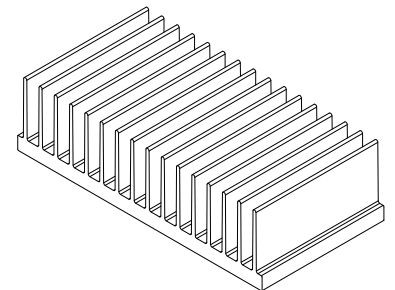
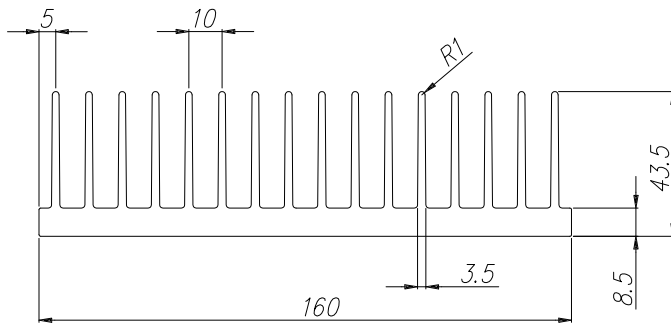

C

TECNODAL
BOLOGNA - ITALY

KA160

Peso Kg/m **7.70**
Weight Kg/m

Rt °C/W **0.69**

Lung. campione mm **150**
Sample length mm

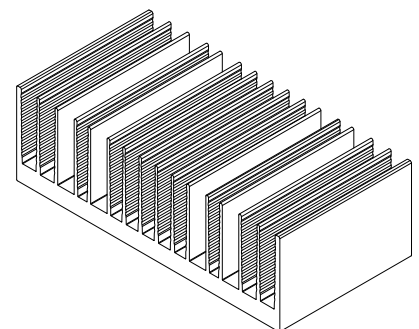
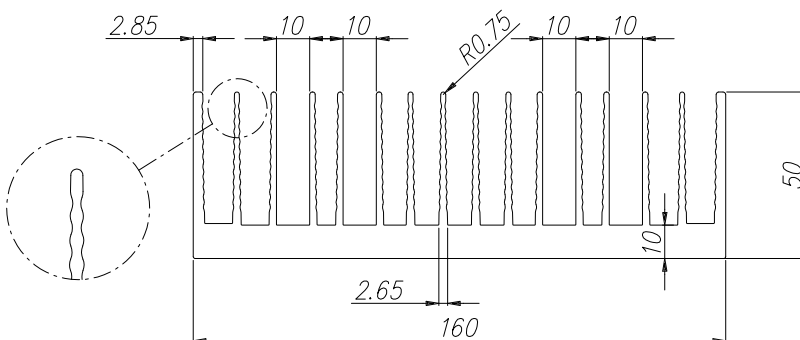

D

TECNODAL
BOLOGNA - ITALY

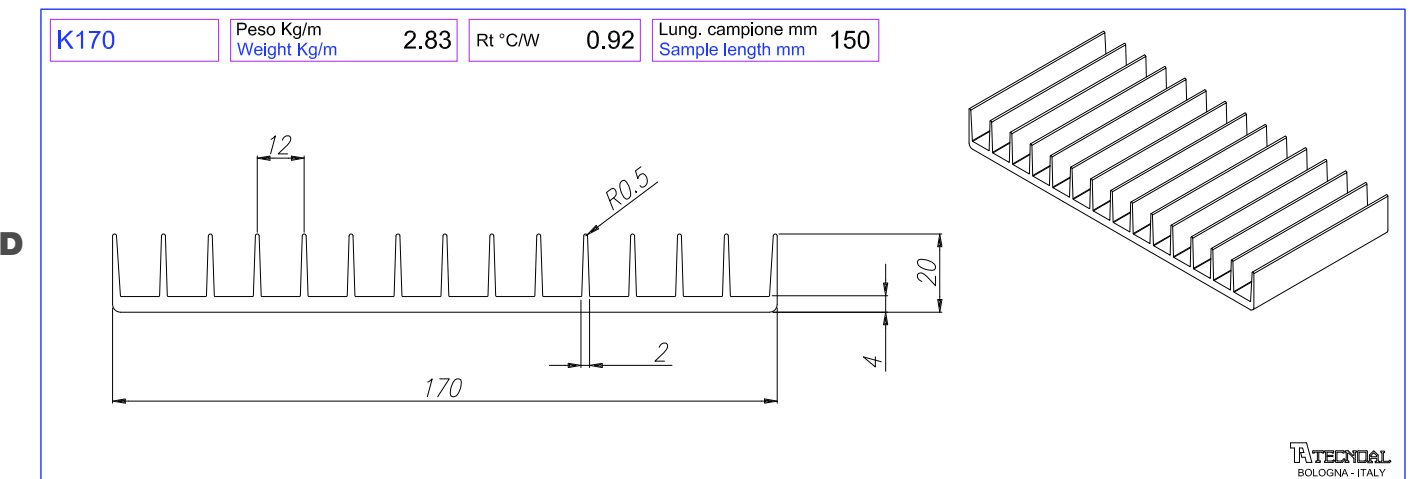
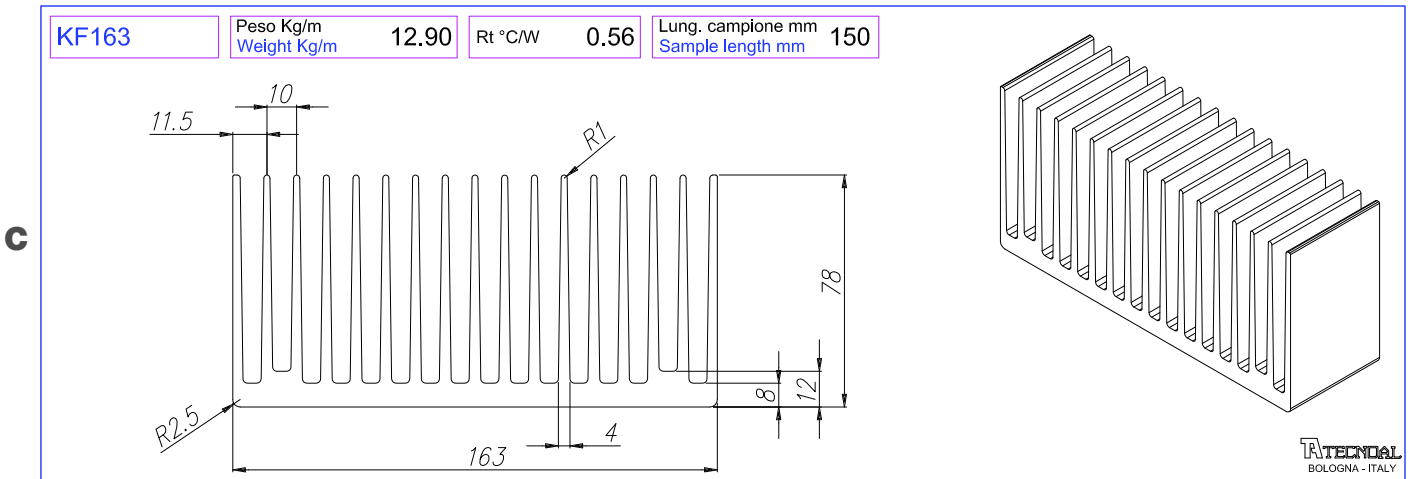
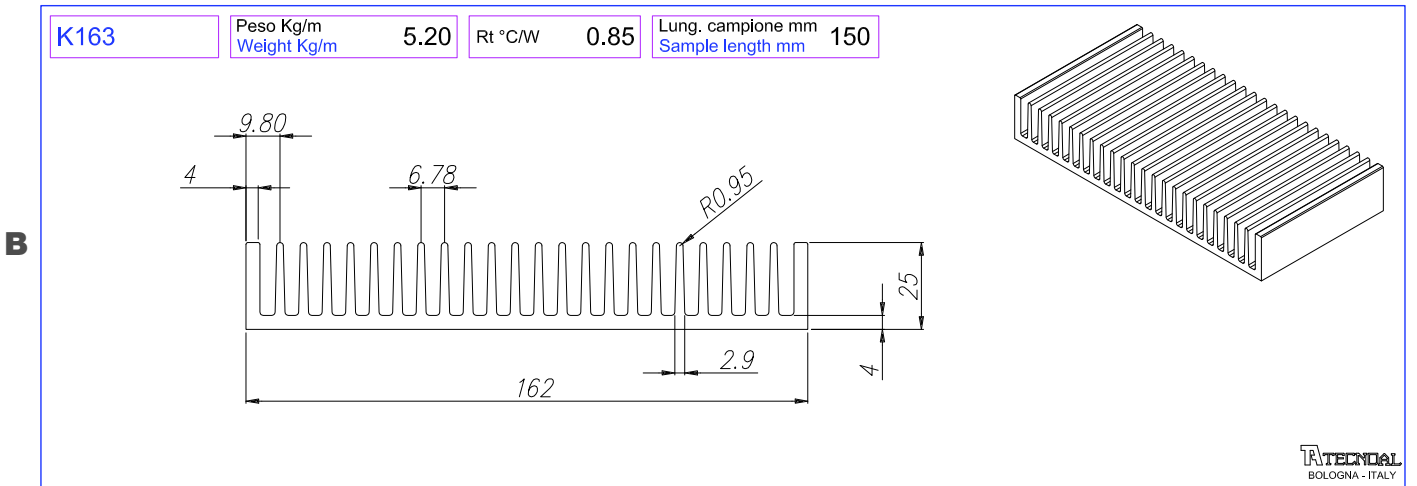
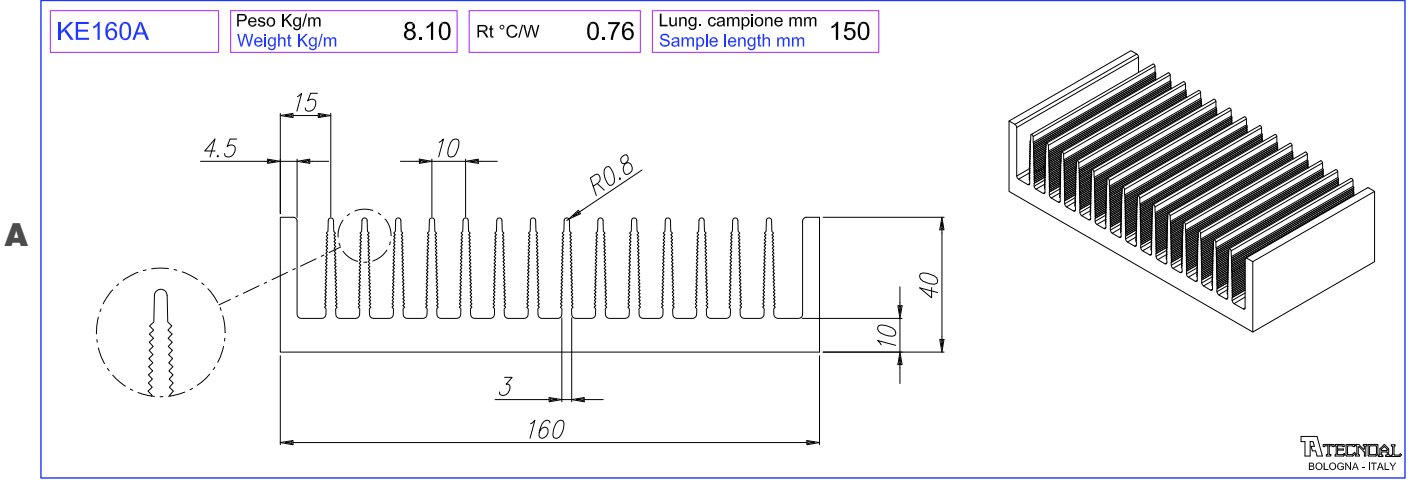



K170	Peso Kg/m Weight Kg/m	14.90	Rt °C/W	0.3	Lung. campione mm Sample length mm	200
-------------	--------------------------	--------------	---------	------------	---------------------------------------	------------

Technical drawing of sample K170 showing dimensions: 21.5, 15.9, R1.2, 90, 16, 170. Includes a 3D perspective view labeled 'A'.

A

TECNOAL
BOLOGNA - ITALY

K173	Peso Kg/m Weight Kg/m	4.60	Rt °C/W	0.80	Lung. campione mm Sample length mm	150
-------------	--------------------------	-------------	---------	-------------	---------------------------------------	------------

Technical drawing of sample K173 showing dimensions: 16.8, 8.2, 28, 4, 2.3, 173. Includes a 3D perspective view labeled 'B'.

B

TECNOAL
BOLOGNA - ITALY

I 100	Peso Kg/m Weight Kg/m	17.1	Rt °C/W	0.41	Lung. campione mm Sample length mm	150
--------------	--------------------------	-------------	---------	-------------	---------------------------------------	------------

Technical drawing of sample I 100 showing dimensions: 15.9, R1.2, 100, 24, 5, 20, 175. Includes a 3D perspective view labeled 'C'.

C

TECNOAL
BOLOGNA - ITALY

K177	Peso Kg/m Weight Kg/m	6.13	Rt °C/W	0.50	Lung. campione mm Sample length mm	150
-------------	--------------------------	-------------	---------	-------------	---------------------------------------	------------

Technical drawing of sample K177 showing dimensions: 12.5, 12.55, R0.9, 50, 4.7, 3, 177.5. Includes a 3D perspective view labeled 'D'.

D

TECNOAL
BOLOGNA - ITALY

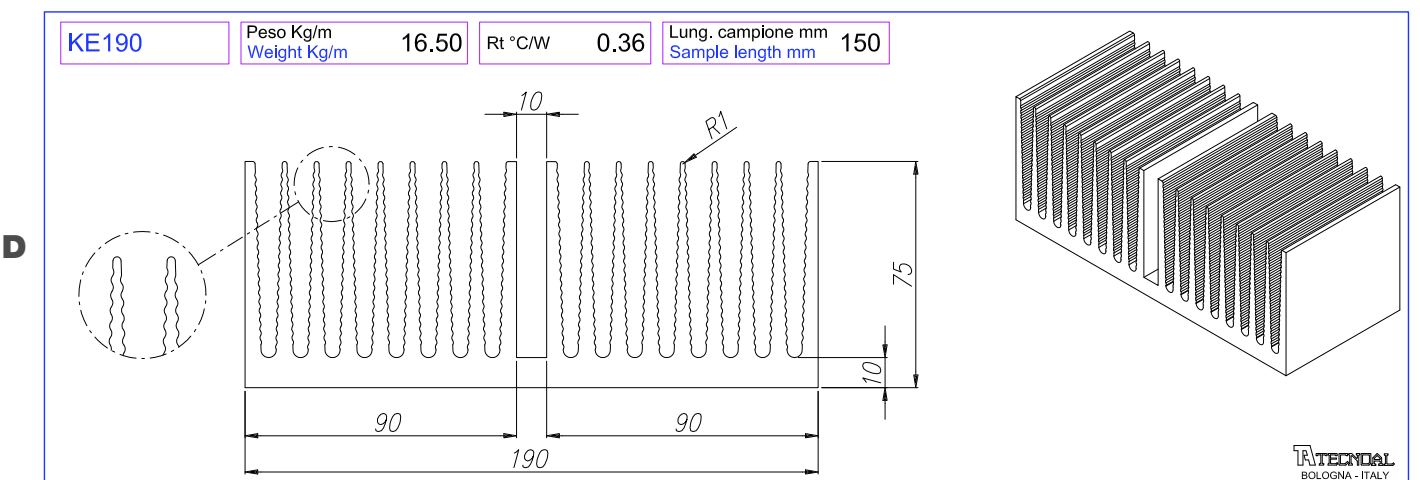
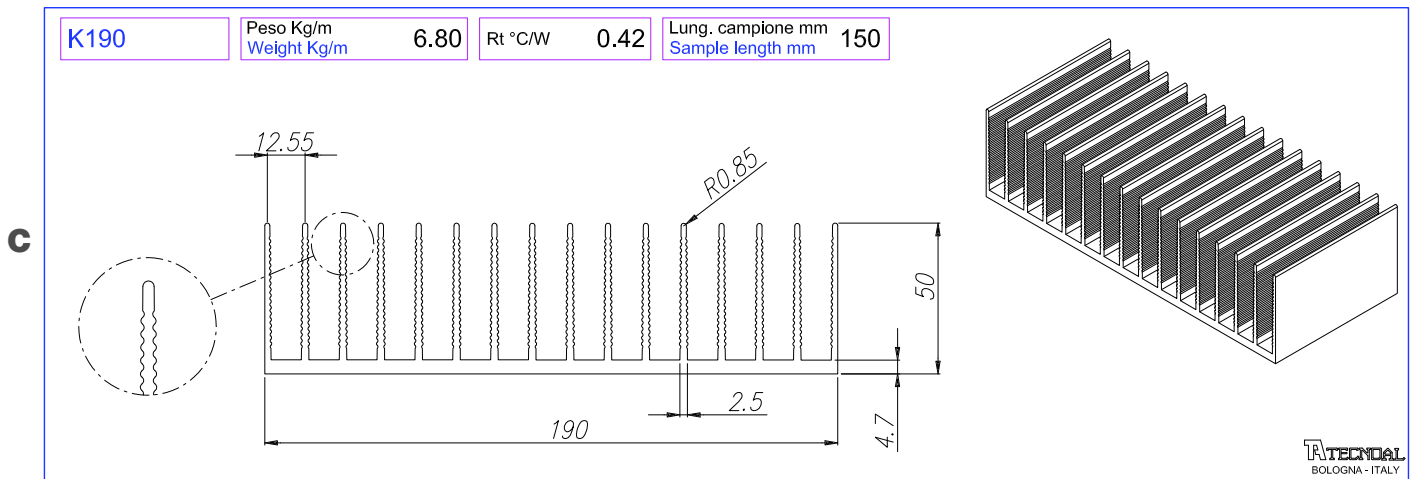
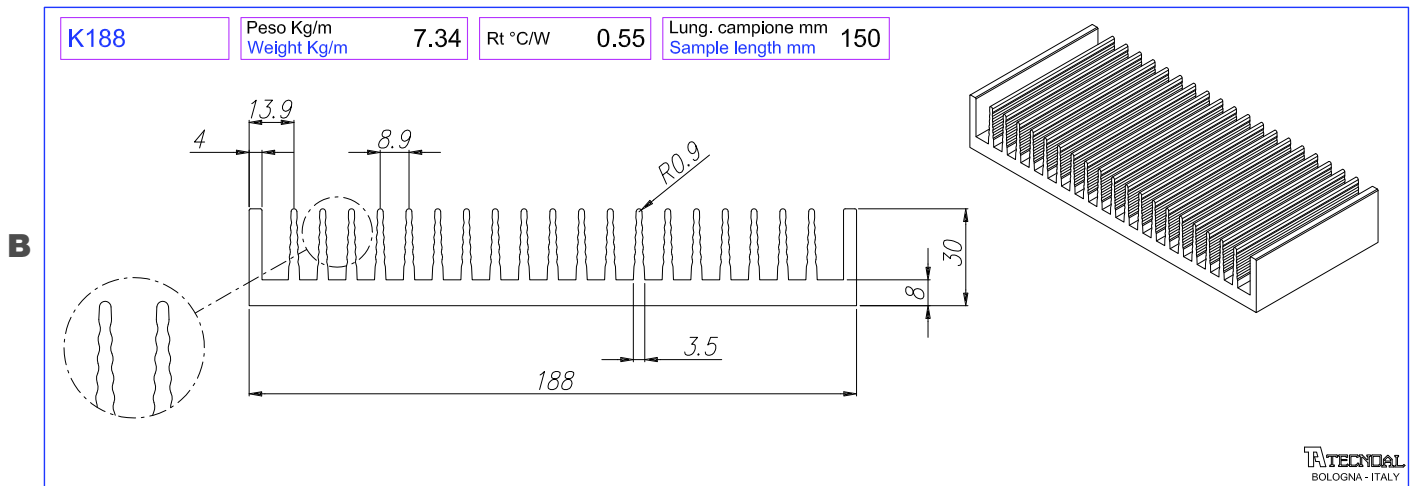
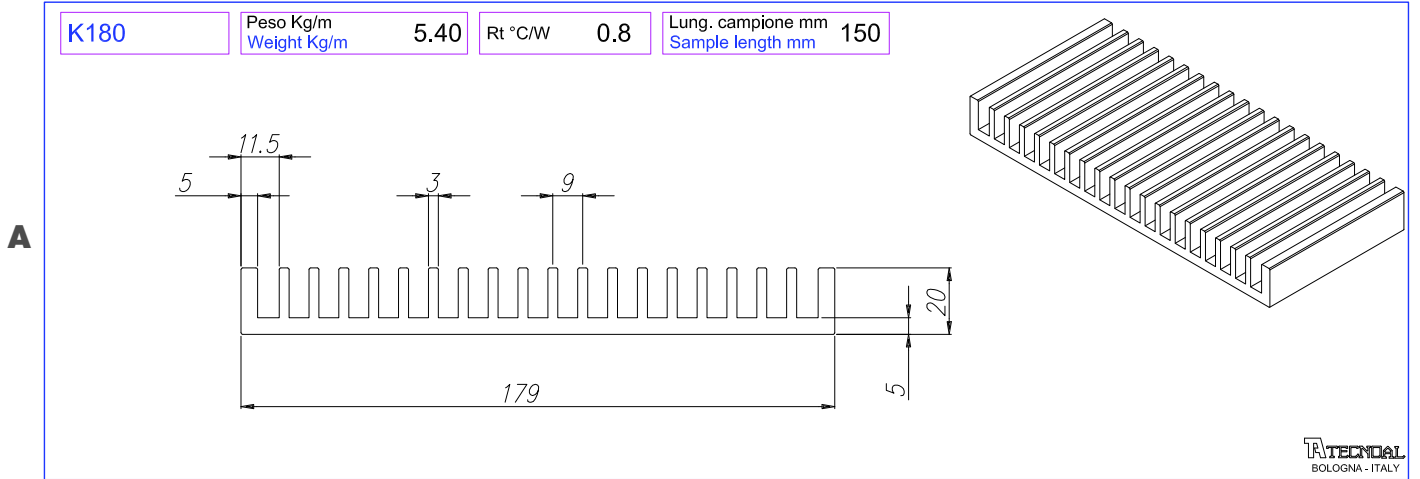



KK190	Peso Kg/m Weight Kg/m	3.64	Rt °C/W	0.9	Lung. campione mm Sample length mm	150
--------------	--------------------------	-------------	---------	------------	---------------------------------------	------------

A

TECNOAL
BOLOGNA - ITALY

K197	Peso Kg/m Weight Kg/m	5.80	Rt °C/W	0.75	Lung. campione mm Sample length mm	150
-------------	--------------------------	-------------	---------	-------------	---------------------------------------	------------

B

TECNOAL
BOLOGNA - ITALY

KE197	Peso Kg/m Weight Kg/m	4.30	Rt °C/W	0.87	Lung. campione mm Sample length mm	150
--------------	--------------------------	-------------	---------	-------------	---------------------------------------	------------

C

TECNOAL
BOLOGNA - ITALY

K200	Peso Kg/m Weight Kg/m	8.20	Rt °C/W	0.50	Lung. campione mm Sample length mm	150
-------------	--------------------------	-------------	---------	-------------	---------------------------------------	------------

D

TECNOAL
BOLOGNA - ITALY



A

K200B	Peso Kg/m Weight Kg/m	8.70	Rt °C/W	0.50	Lung. campione mm Sample length mm	150
--------------	--------------------------	-------------	---------	-------------	---------------------------------------	------------

TECNODAL BOLOGNA - ITALY

B

KL200	Peso Kg/m Weight Kg/m	7.60	Rt °C/W	0.82	Lung. campione mm Sample length mm	150
--------------	--------------------------	-------------	---------	-------------	---------------------------------------	------------

TECNODAL BOLOGNA - ITALY

C

KA200	Peso Kg/m Weight Kg/m	19.90	Rt °C/W	0.34	Lung. campione mm Sample length mm	150
--------------	--------------------------	--------------	---------	-------------	---------------------------------------	------------

TECNODAL BOLOGNA - ITALY

D

KE200	Peso Kg/m Weight Kg/m	15.00	Rt °C/W	0.39	Lung. campione mm Sample length mm	150
--------------	--------------------------	--------------	---------	-------------	---------------------------------------	------------

TECNODAL BOLOGNA - ITALY



KEA200				
Peso Kg/m Weight Kg/m	8.90			
Rt °C/W	0.36			
Lung. campione mm Sample length mm	150			

A

TECNODAL
BOLOGNA - ITALY

KEAH200	Peso Kg/m Weight Kg/m	5.50	Rt °C/W	0.64	Lung. campione mm Sample length mm	150
----------------	--------------------------	------	---------	------	---------------------------------------	-----

B

TECNODAL
BOLOGNA - ITALY

KEI200	Peso Kg/m Weight Kg/m	2.84	Rt °C/W	1.6	Lung. campione mm Sample length mm	150
---------------	--------------------------	------	---------	-----	---------------------------------------	-----

C

TECNODAL
BOLOGNA - ITALY

KEIA200				
Peso Kg/m Weight Kg/m	15.60			
Rt °C/W	0.39			
Lung. campione mm Sample length mm	150			

D

TECNODAL
BOLOGNA - ITALY



A

KK200

Peso Kg/m
Weight Kg/m

4.00

Rt °C/W

0.85

Lung. campione mm
Sample length mm

150

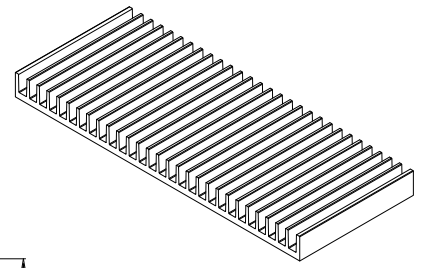
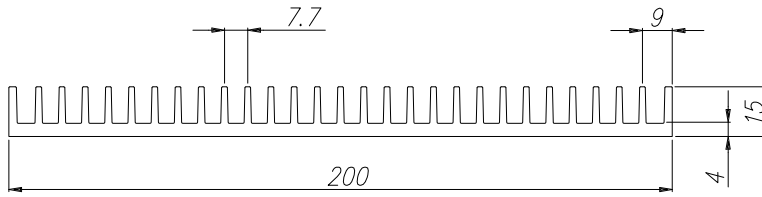

TECNOAL
BOLOGNA - ITALY

B

KH200

Peso Kg/m
Weight Kg/m

17.70

Rt °C/W

0.30

Lung. campione mm
Sample length mm

150

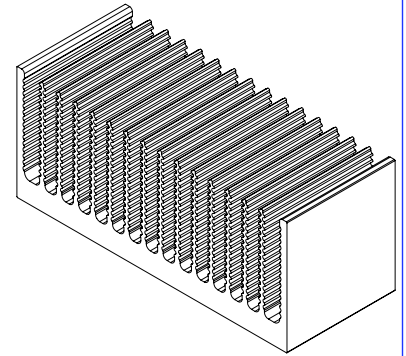
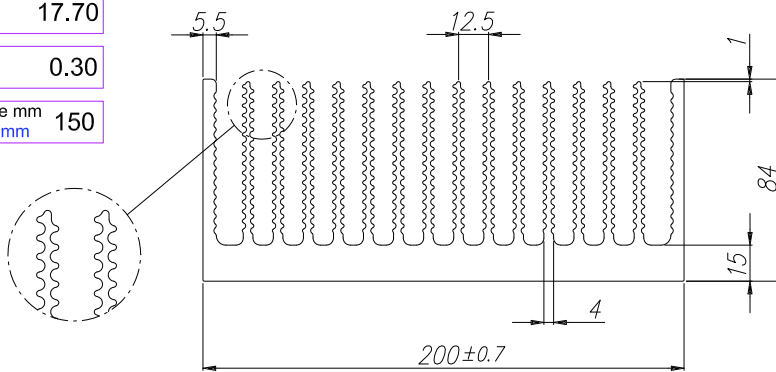

TECNOAL
BOLOGNA - ITALY

C

KS200

Peso Kg/m
Weight Kg/m

15.00

Rt °C/W

0.35

Lung. campione mm
Sample length mm

150

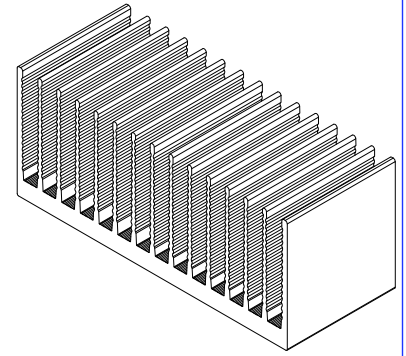
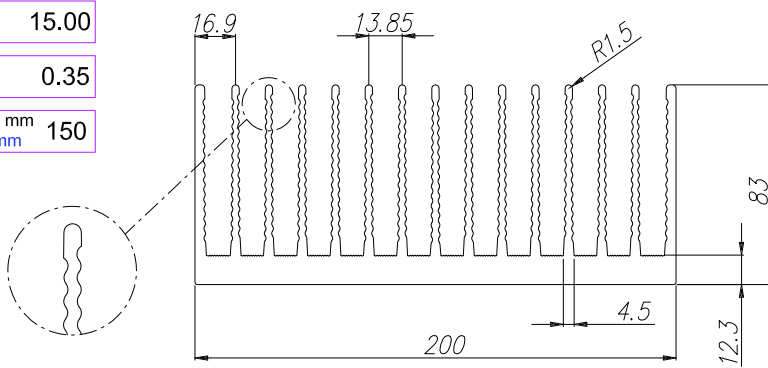

TECNOAL
BOLOGNA - ITALY

D

KX200

Peso Kg/m
Weight Kg/m

17.40

Rt °C/W

0.32

Lung. campione mm
Sample length mm

150

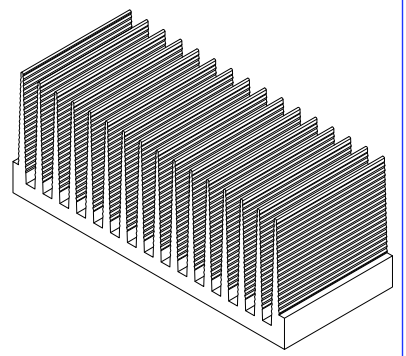
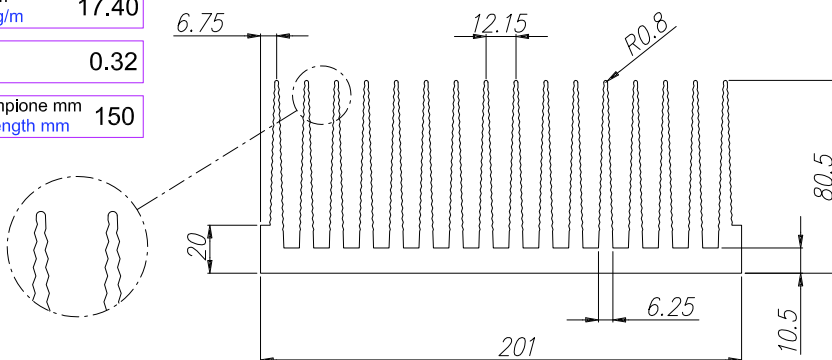

TECNOAL
BOLOGNA - ITALY



KXC140

Peso Kg/m **1.95**
Weight Kg/m

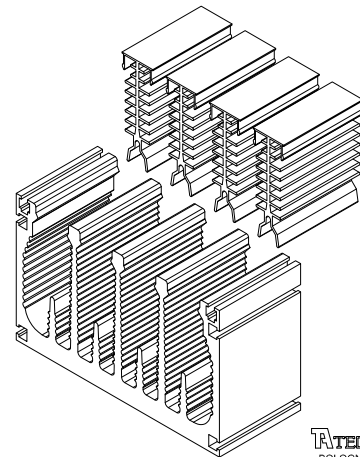
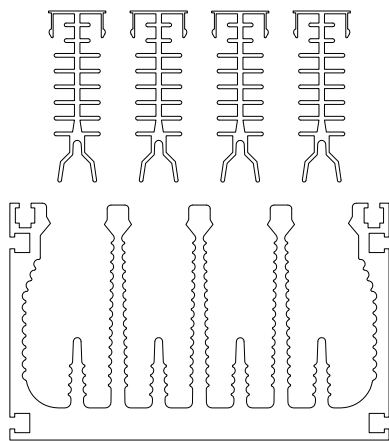

A

TECNOAL
BOLOGNA - ITALY

KXE200

Peso Kg/m **23.30**
Weight Kg/m

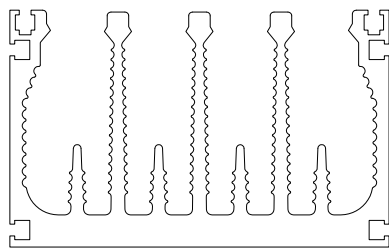

KXH200

Peso Kg/m **31.10**
Weight Kg/m

Rt °C/W **0.10**

Lung. campione mm **300**
Sample length mm

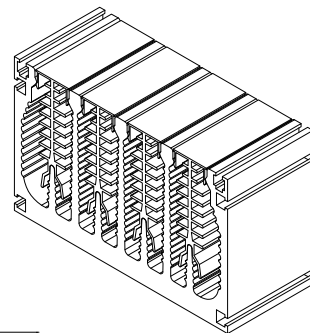
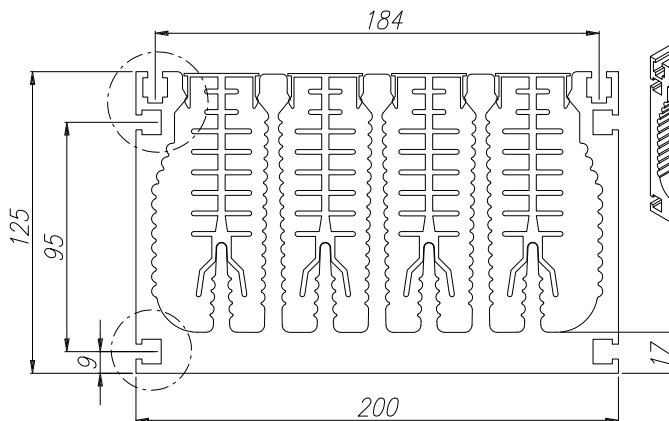
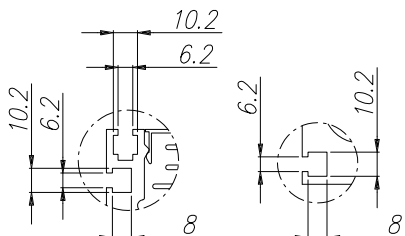

B

TECNOAL
BOLOGNA - ITALY

KC205

Peso Kg/m **4.30**
Weight Kg/m

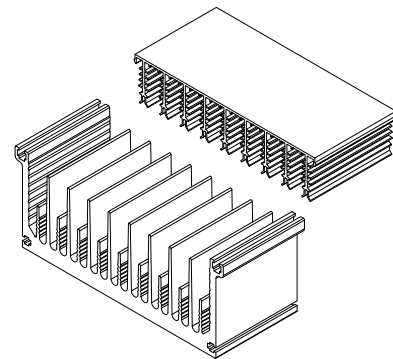
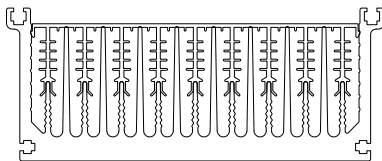
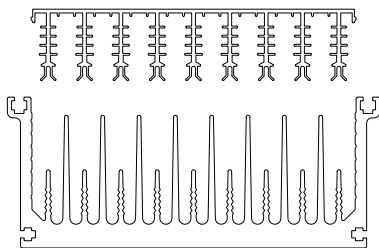

C

TECNOAL
BOLOGNA - ITALY

KE205

Peso Kg/m **15.50**
Weight Kg/m

K205

Peso Kg/m **20.20**
Weight Kg/m

Rt °C/W **0.30**

Lung. campione mm **300**
Sample length mm

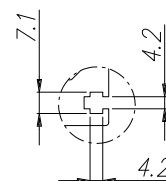
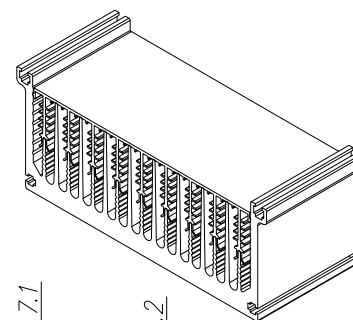
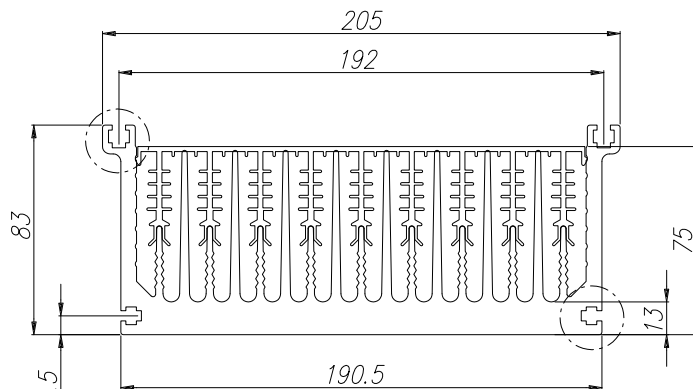
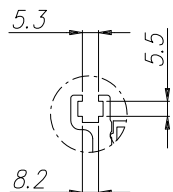

D

TECNOAL
BOLOGNA - ITALY



A

KF212 Peso Kg/m 8.20 Rt °C/W 0.85 Lung. campione mm 150
 Weight Kg/m Sample length mm

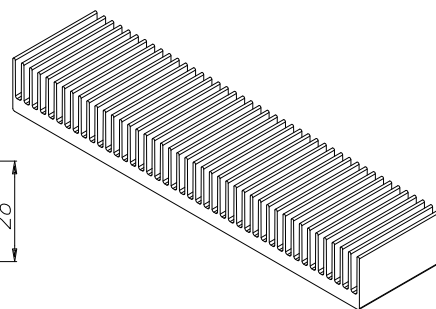
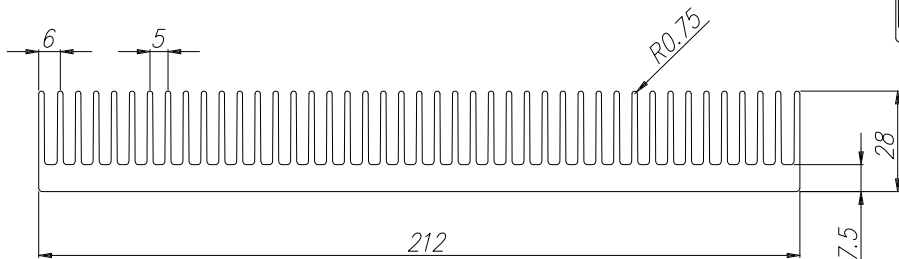

Ventilazione forzata Forced ventilation	Rt °C/W 0.074	Velocità dell'aria in uscita (m/sec) Outgoing air speed (m/sec)	3.0	Lung. campione mm 150 Sample length mm
Ventilazione forzata Forced ventilation	Rt °C/W 0.062	Velocità dell'aria in uscita (m/sec) Outgoing air speed (m/sec)	5.0	Lung. campione mm 150 Sample length mm

TECNOAL
BOLOGNA - ITALY

B

K213 Peso Kg/m 5.00 Rt °C/W 0.56 Lung. campione mm 150
 Weight Kg/m Sample length mm

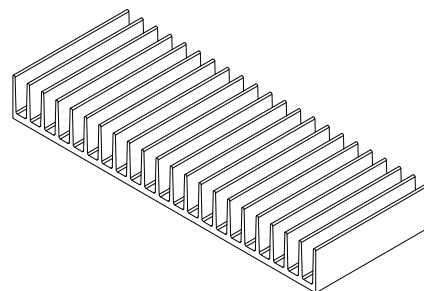
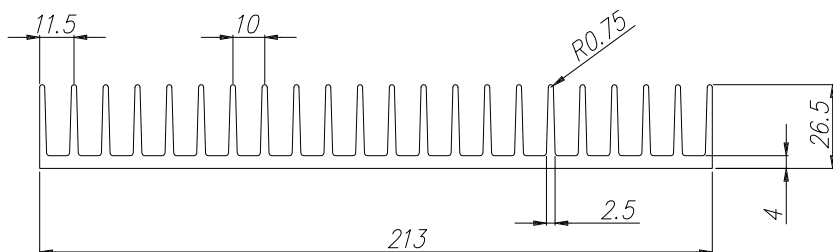

TECNOAL
BOLOGNA - ITALY

C

K215
 Peso Kg/m 22.40
 Weight Kg/m
 Rt °C/W 0.33
 Lung. campione mm 150
 Sample length mm

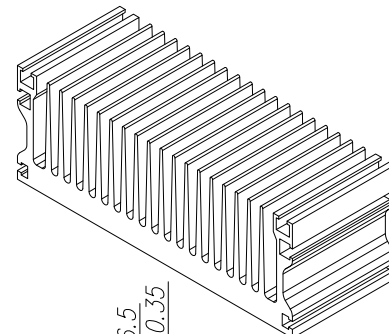
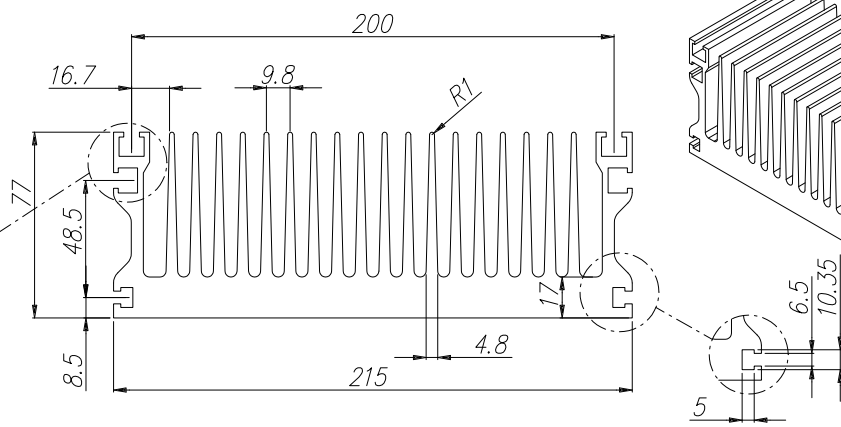
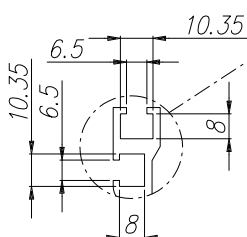

TECNOAL
BOLOGNA - ITALY

D

KE215
 Peso Kg/m 20.90
 Weight Kg/m
 Rt °C/W 0.36
 Lung. campione mm 150
 Sample length mm

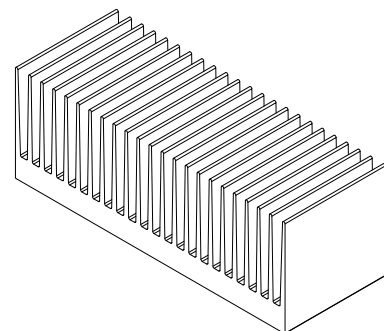
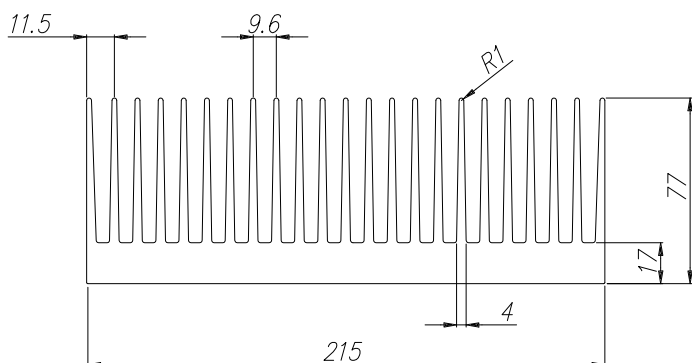

TECNOAL
BOLOGNA - ITALY



KF215	Peso Kg/m Weight Kg/m	16.75	Rt °C/W	0.637	Lung. campione mm Sample length mm	150
--------------	--------------------------	--------------	---------	--------------	---------------------------------------	------------

Ventilazione forzata Forced ventilation	Rt °C/W	0.043	Velocità dell'aria in uscita (m/sec) Outgoing air speed (m/sec)	5.0	Lung. campione mm Sample length mm	150
--	---------	--------------	--	------------	---------------------------------------	------------

TECNOAL
BOLOGNA - ITALY

A

K216	Peso Kg/m Weight Kg/m	24.00	Rt °C/W	0.35	Lung. campione mm Sample length mm	150
-------------	--------------------------	--------------	---------	-------------	---------------------------------------	------------

TECNOAL
BOLOGNA - ITALY

B

KX216	Peso Kg/m Weight Kg/m	18.50	Rt °C/W	0.36	Lung. campione mm Sample length mm	150
--------------	--------------------------	--------------	---------	-------------	---------------------------------------	------------

TECNOAL
BOLOGNA - ITALY

C

K220	Peso Kg/m Weight Kg/m	18.80	Rt °C/W	0.28	Lung. campione mm Sample length mm	150
-------------	--------------------------	--------------	---------	-------------	---------------------------------------	------------

TECNOAL
BOLOGNA - ITALY

D



A

K222 **Peso Kg/m** **17.00** **Rt °C/W** **0.28** **Lung. campione mm** **200**
Weight Kg/m **Sample length mm**

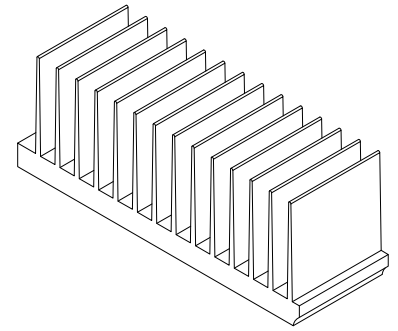
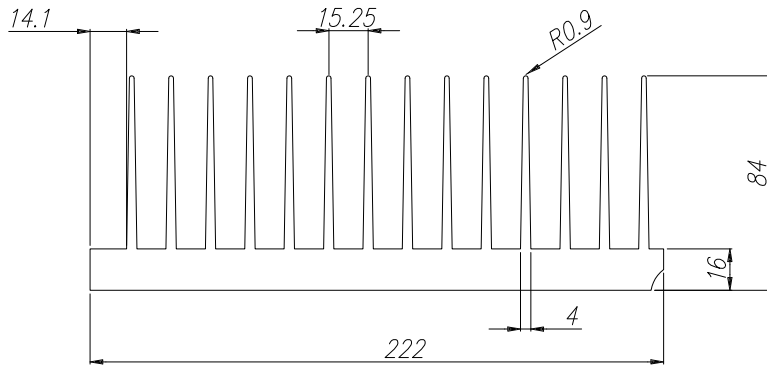

TECNOAL
BOLOGNA - ITALY

B

K223 **Peso Kg/m** **5.14** **Rt °C/W** **0.82** **Lung. campione mm** **150**
Weight Kg/m **Sample length mm**

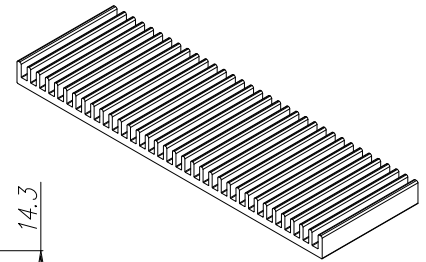
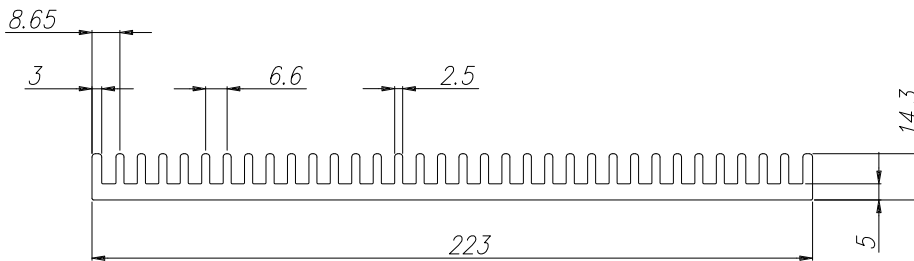

Ventilazione forzata **Rt °C/W** **0.125** **Velocità dell'aria in uscita (m/sec)** **5.0** **Lung. campione mm** **150**
Forced ventilation **Outgoing air speed (m/sec)** **Sample length mm**

TECNOAL
BOLOGNA - ITALY

C

KE223 **Peso Kg/m** **5.90** **Rt °C/W** **0.55** **Lung. campione mm** **150**
Weight Kg/m **Sample length mm**

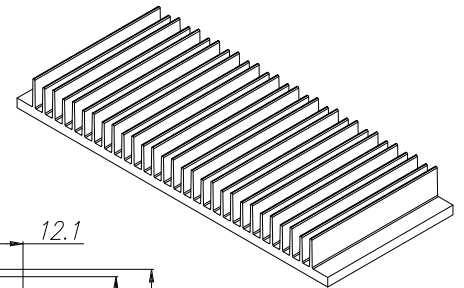
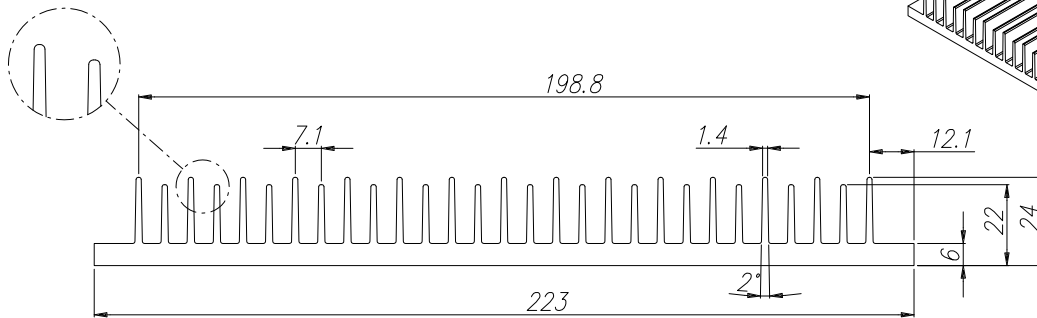

TECNOAL
BOLOGNA - ITALY

D

K224 **Peso Kg/m** **6.70** **Rt °C/W** **0.44** **Lung. campione mm** **150**
Weight Kg/m **Sample length mm**

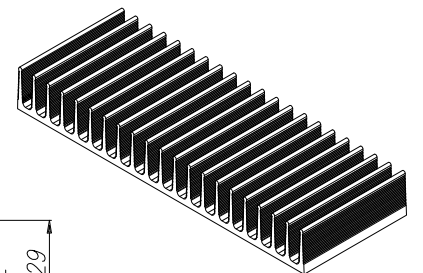
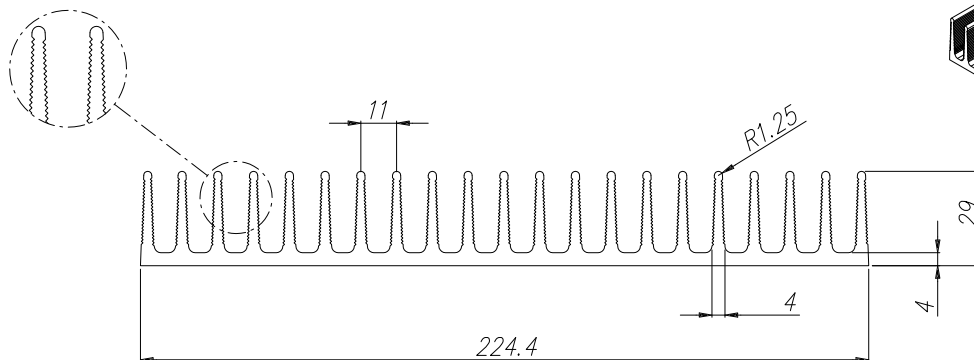

TECNOAL
BOLOGNA - ITALY



KE224	Peso Kg/m Weight Kg/m	6.70	Rt °C/W	0.49	Lung. campione mm Sample length mm	150
--------------	--------------------------	-------------	---------	-------------	---------------------------------------	------------

A

TECNOAL
BOLOGNA - ITALY

K230	Peso Kg/m Weight Kg/m	17.50	Rt °C/W	0.30	Lung. campione mm Sample length mm	150
-------------	--------------------------	--------------	---------	-------------	---------------------------------------	------------

B

TECNOAL
BOLOGNA - ITALY

K235	Peso Kg/m Weight Kg/m	14.70	Rt °C/W	0.35	Lung. campione mm Sample length mm	150
-------------	--------------------------	--------------	---------	-------------	---------------------------------------	------------

C

TECNOAL
BOLOGNA - ITALY

KF240	Peso Kg/m Weight Kg/m	16.50	Rt °C/W	0,54	Lung. campione mm Sample length mm	150
--------------	--------------------------	--------------	---------	-------------	---------------------------------------	------------

D

TECNOAL
BOLOGNA - ITALY

ONLY FOR FORCED VENTILATION

Ventilazione forzata Forced ventilation	Rt °C/W	0,043	Velocità dell'aria in uscita (m/sec) Outgoing air speed (m/sec)	6,0	Lung. campione mm Sample length mm	200
--	---------	--------------	--	------------	---------------------------------------	------------



K245

Peso Kg/m
Weight Kg/m 6.60

Rt °C/W 0.49

Lung. campione mm
Sample length mm 150

A

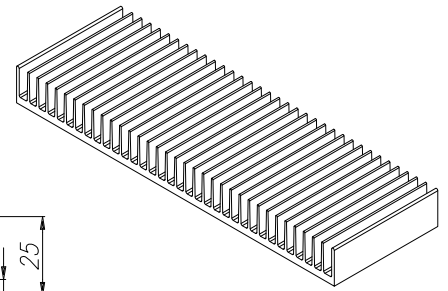
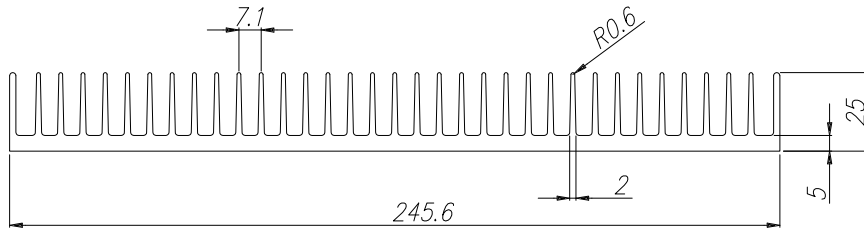

TECNOAL
BOLOGNA - ITALY

K250

Peso Kg/m
Weight Kg/m 12.5

Rt °C/W 0.40

Lung. campione mm
Sample length mm 150

B

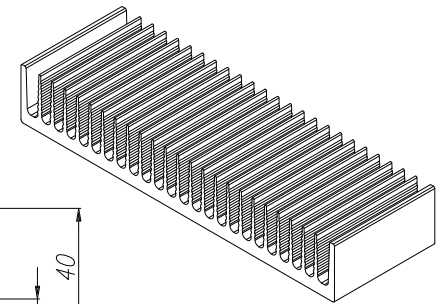
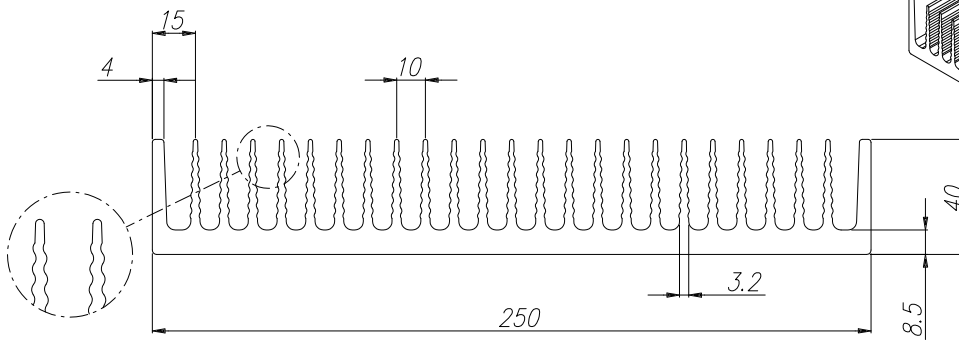

TECNOAL
BOLOGNA - ITALY

K250E

Peso Kg/m
Weight Kg/m 13.25

Rt °C/W 0.41

Lung. campione mm
Sample length mm 150

C

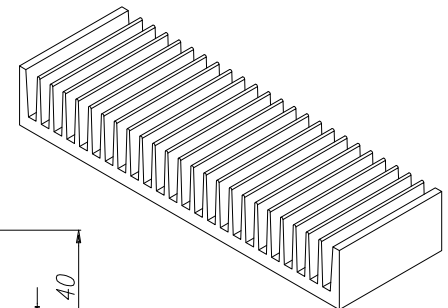
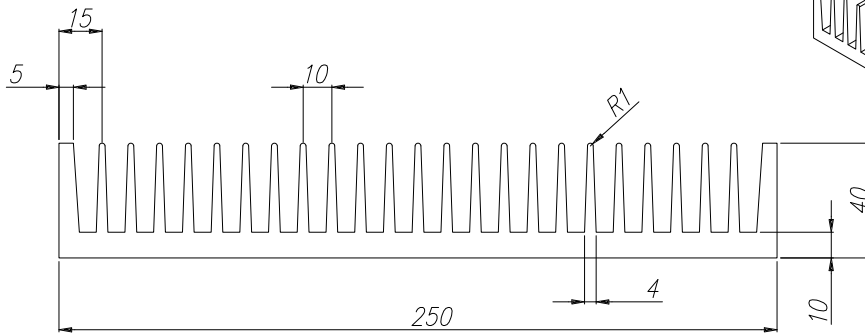

TECNOAL
BOLOGNA - ITALY

KE250

Peso Kg/m
Weight Kg/m 22.05

Rt °C/W 0.22

Lung. campione mm
Sample length mm 150

D

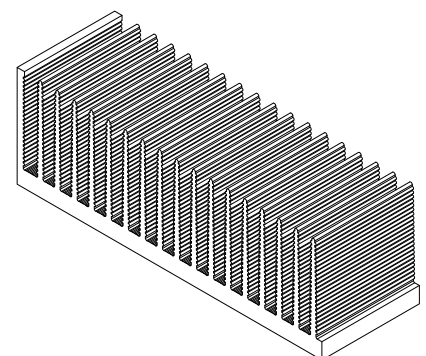
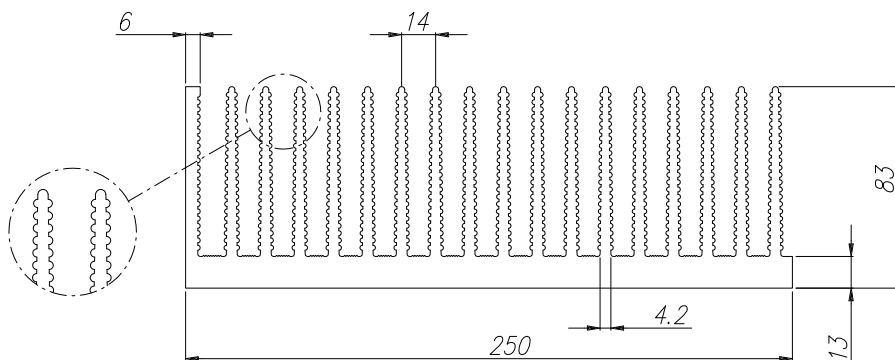

TECNOAL
BOLOGNA - ITALY



KX250	Peso Kg/m Weight Kg/m	25.10	Rt °C/W	0.23	Lung. campione mm Sample length mm	150
--------------	--------------------------	--------------	---------	-------------	---------------------------------------	------------

A

TECNOAL
BOLOGNA - ITALY

KK250	Peso Kg/m Weight Kg/m	21.40	Rt °C/W	0.24	Lung. campione mm Sample length mm	150
--------------	--------------------------	--------------	---------	-------------	---------------------------------------	------------

B

TECNOAL
BOLOGNA - ITALY

K260	Peso Kg/m Weight Kg/m	20.65	Rt °C/W	0.29	Lung. campione mm Sample length mm	150
-------------	--------------------------	--------------	---------	-------------	---------------------------------------	------------

C

TECNOAL
BOLOGNA - ITALY

K300	Peso Kg/m Weight Kg/m	12.80	Rt °C/W	0.32	Lung. campione mm Sample length mm	150
-------------	--------------------------	--------------	---------	-------------	---------------------------------------	------------

D

TECNOAL
BOLOGNA - ITALY



KE300 **Peso Kg/m** **22.70** **Rt °C/W** **0.21** **Lung. campione mm** **150**
Weight Kg/m **Sample length mm**

A

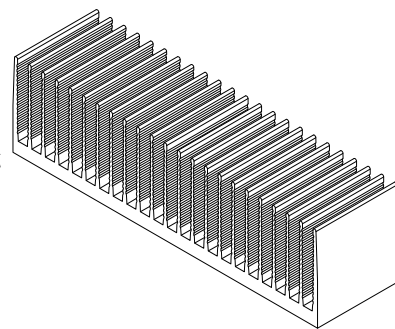
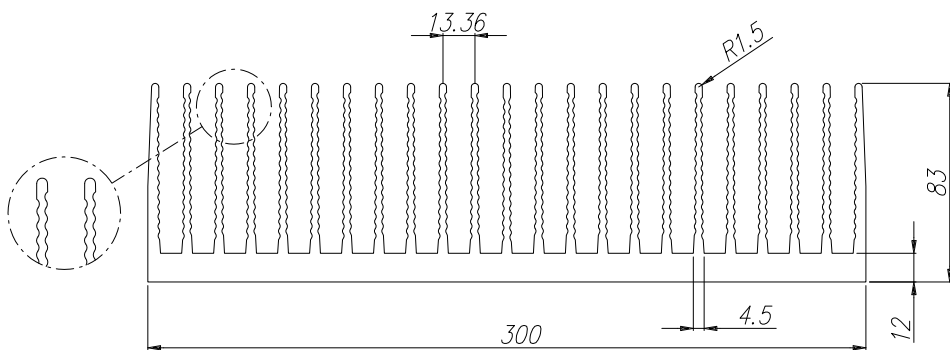

TECNOAL
BOLOGNA - ITALY

KEA300 **Peso Kg/m** **9.10** **Rt °C/W** **0.44** **Lung. campione mm** **150**
Weight Kg/m **Sample length mm**

B

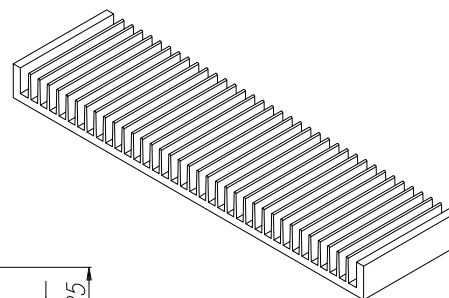
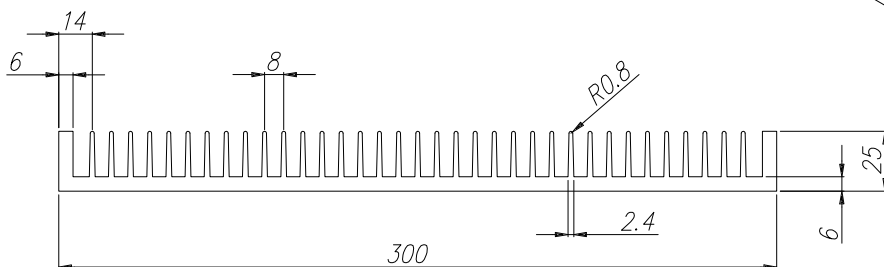

TECNOAL
BOLOGNA - ITALY

KH300 **Peso Kg/m** **26.60** **Rt °C/W** **0.20** **Lung. campione mm** **150**
Weight Kg/m **Sample length mm**

C

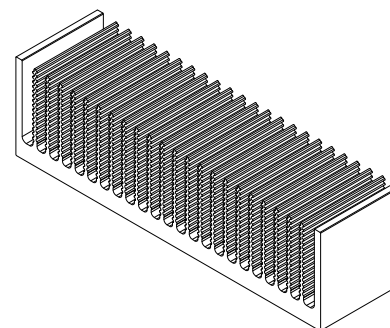
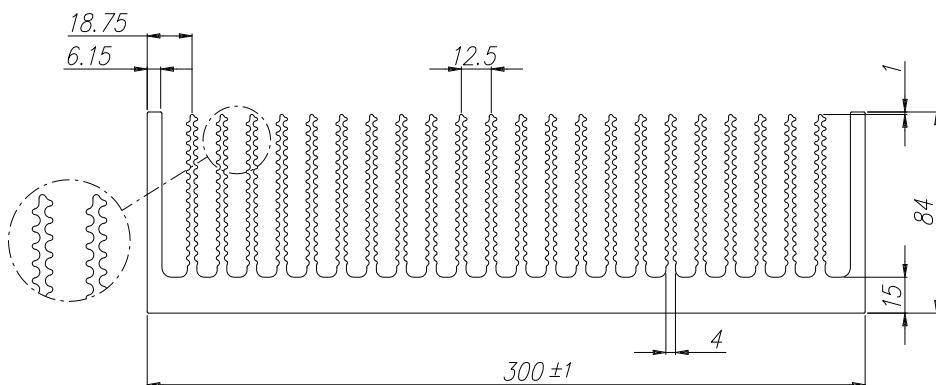

TECNOAL
BOLOGNA - ITALY

KK300 **Peso Kg/m** **15.75** **Rt °C/W** **0.32** **Lung. campione mm** **150**
Weight Kg/m **Sample length mm**

D

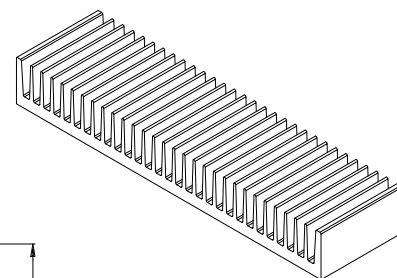
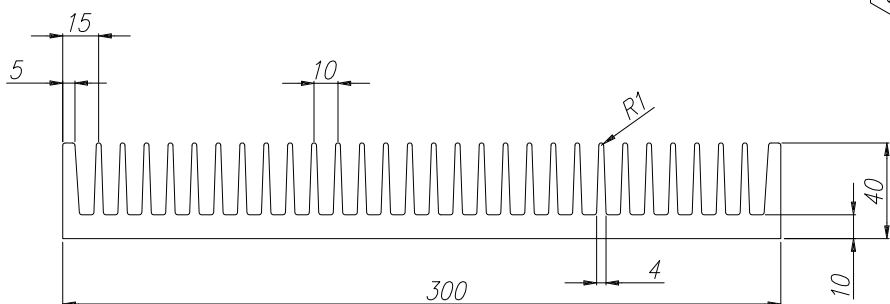

TECNOAL
BOLOGNA - ITALY



KX300	Peso Kg/m Weight Kg/m	28.45	Rt °C/W	0.20	Lung. campione mm Sample length mm	150
--------------	--------------------------	--------------	---------	-------------	---------------------------------------	------------

Technical drawing of KX300 finned tube. Dimensions include: 19.85, 6.15, 13.7, R1.2, 1, 84, 15, 4, 300. Includes an isometric view of the finned tube.

A

TECNOAL
BOLOGNA - ITALY

K310	Peso Kg/m Weight Kg/m	25.95	Rt °C/W	0.21	Lung. campione mm Sample length mm	200
-------------	--------------------------	--------------	---------	-------------	---------------------------------------	------------

Technical drawing of K310 finned tube. Dimensions include: 17, R1.2, 90, 16, 5, 310. Includes an isometric view of the finned tube.

B

TECNOAL
BOLOGNA - ITALY

K330	Peso Kg/m Weight Kg/m	25.20	Rt °C/W	0.19	Lung. campione mm Sample length mm	200
-------------	--------------------------	--------------	---------	-------------	---------------------------------------	------------

Technical drawing of K330 finned tube. Dimensions include: 17.5, 15.14, R0.9, 83, 16, 4, 302.75, 330. Includes an isometric view of the finned tube.

C

TECNOAL
BOLOGNA - ITALY

K400	Peso Kg/m Weight Kg/m	21.03	Rt °C/W	0.25	Lung. campione mm Sample length mm	150
-------------	--------------------------	--------------	---------	-------------	---------------------------------------	------------

Technical drawing of K400 finned tube. Dimensions include: 15, 4.5, 10, 40, 3.7, 10.5, 400. Includes an isometric view of the finned tube.

D

TECNOAL
BOLOGNA - ITALY



K426

Peso Kg/m
Weight Kg/m

6.80

Rt °C/W

0.90

Lung. campione mm
Sample length mm

150

A

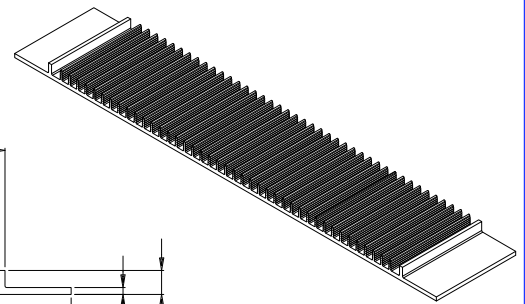
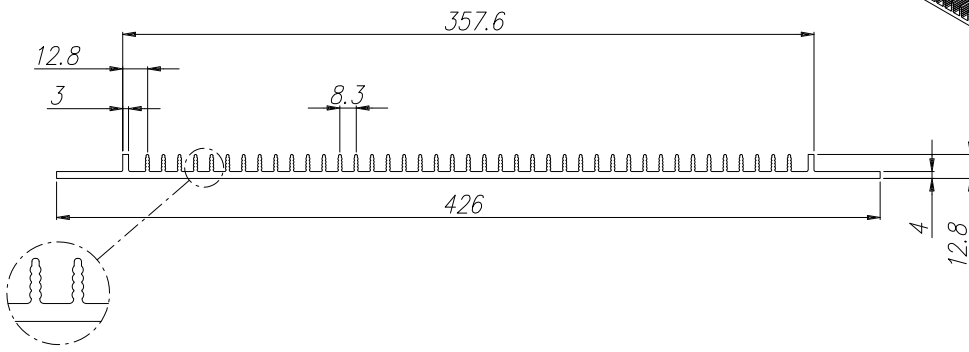

TECNOAL
BOLOGNA - ITALY

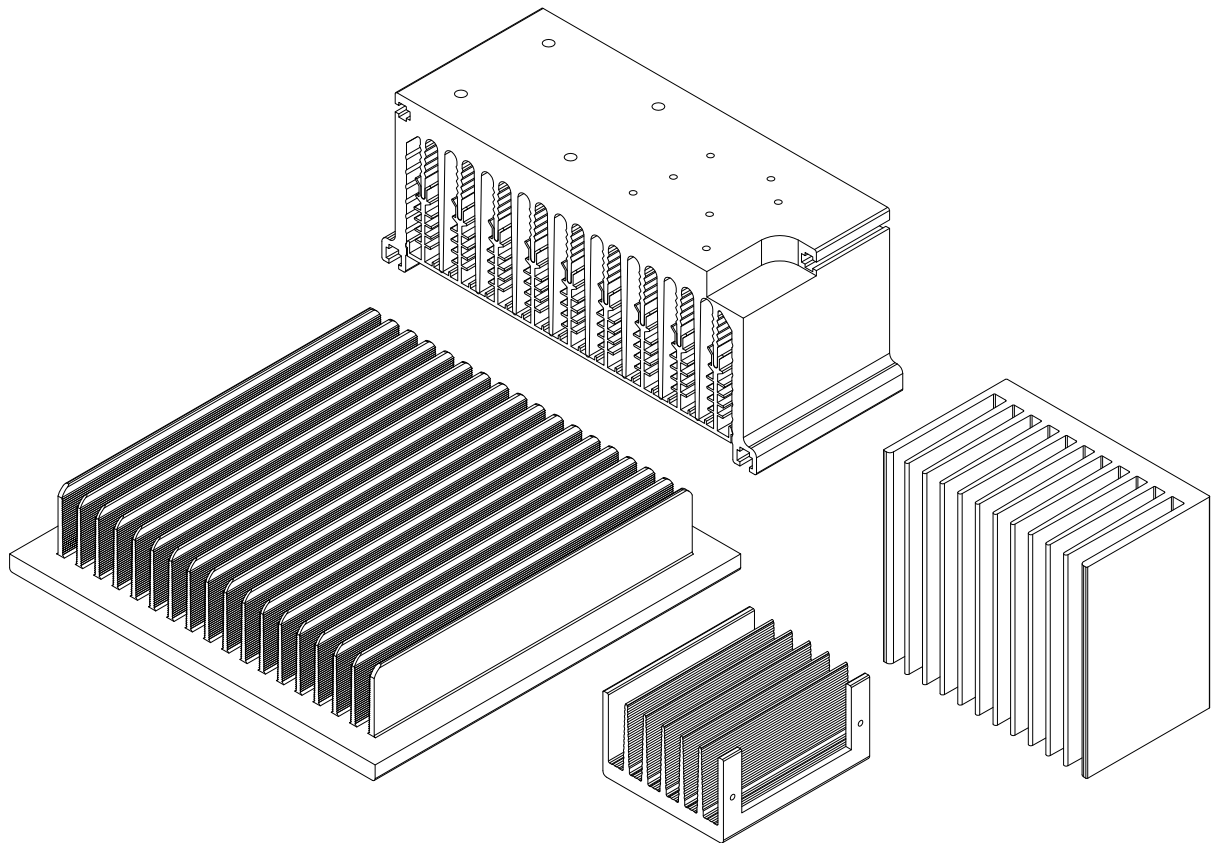

TECNOAL
BOLOGNA - ITALY

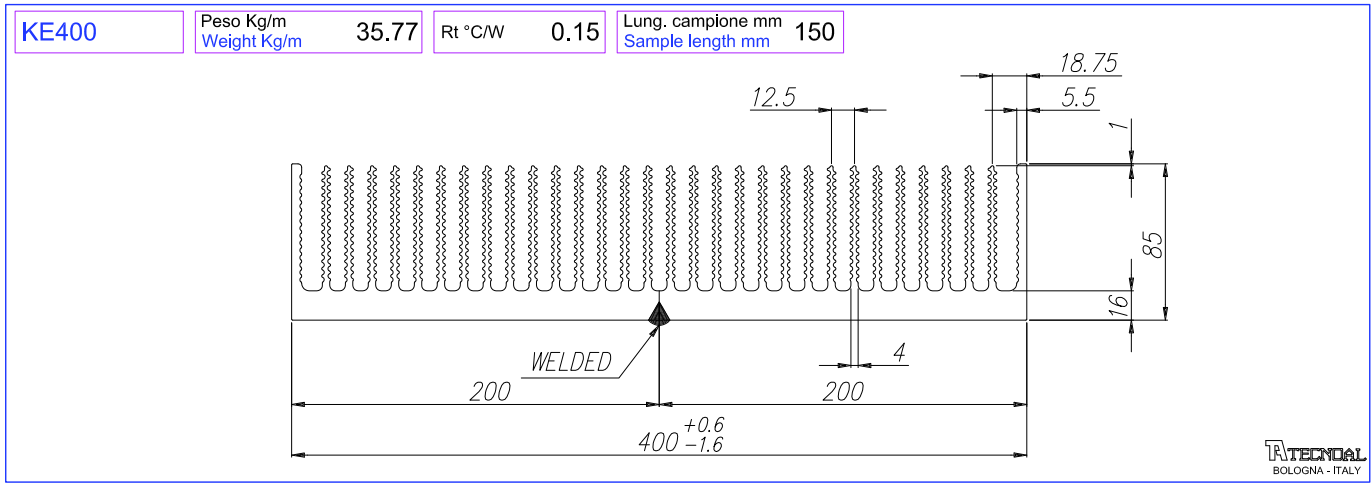

A

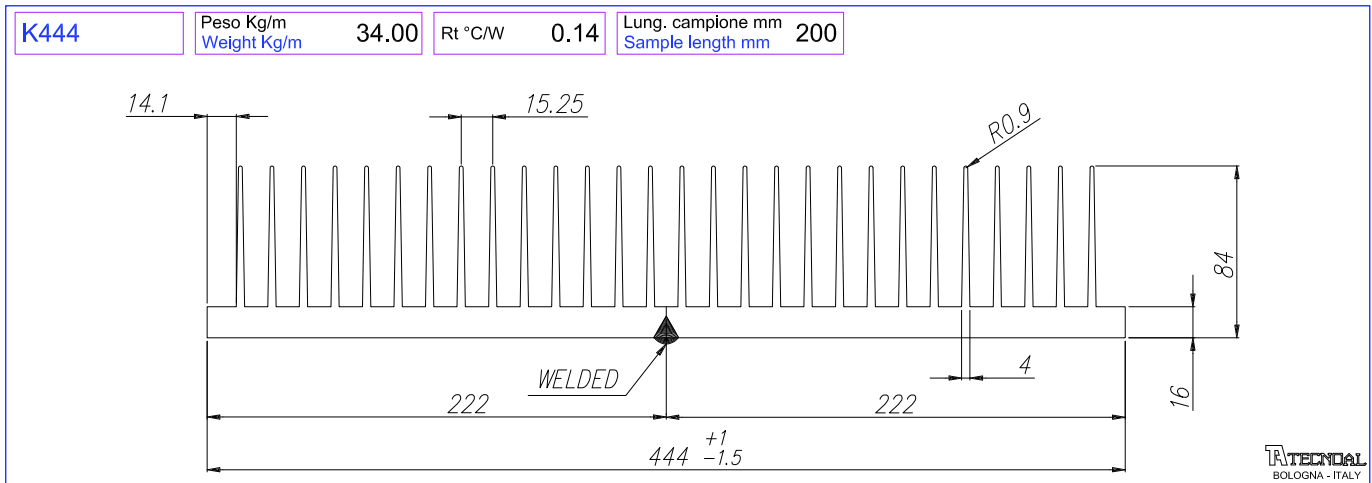

B

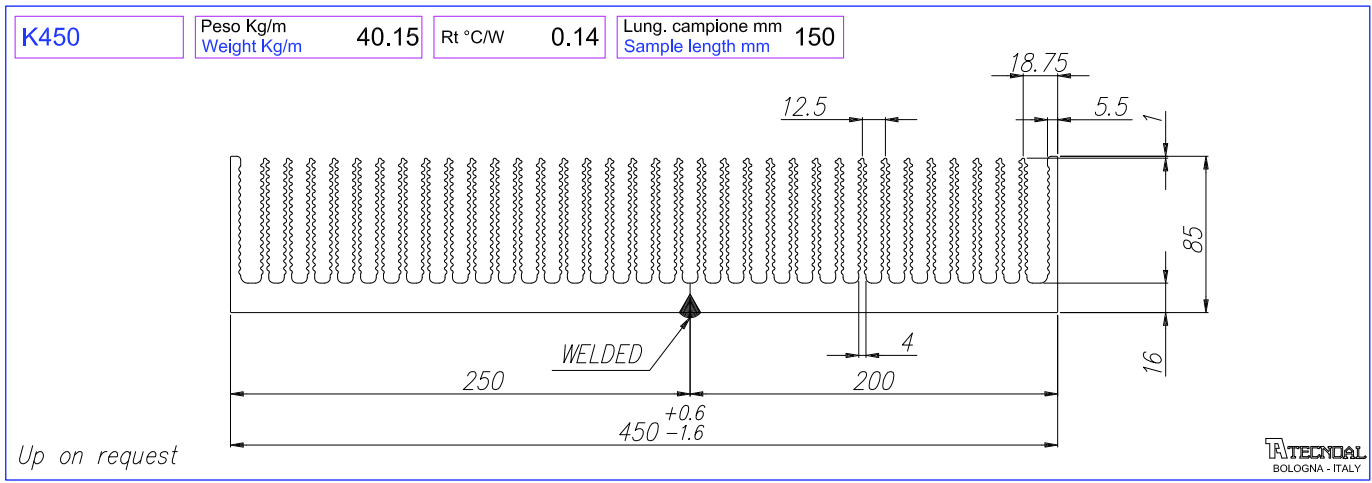

C

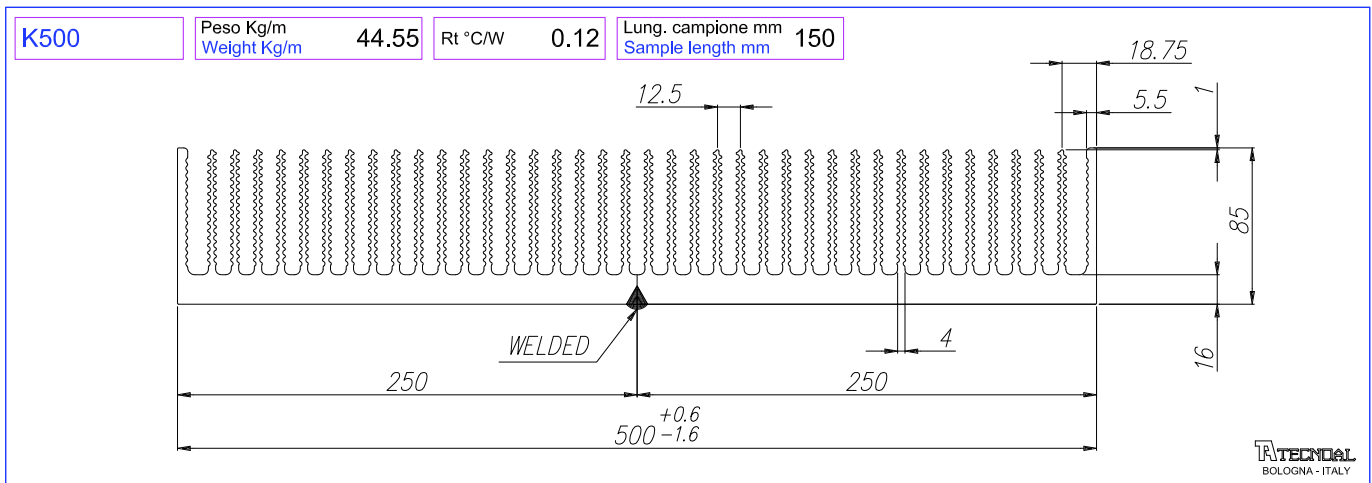

D



A

K500A

Peso Kg/m
Weight Kg/m 44.10

Rt °C/W 0.13

Lung. campione mm
Sample length mm 150

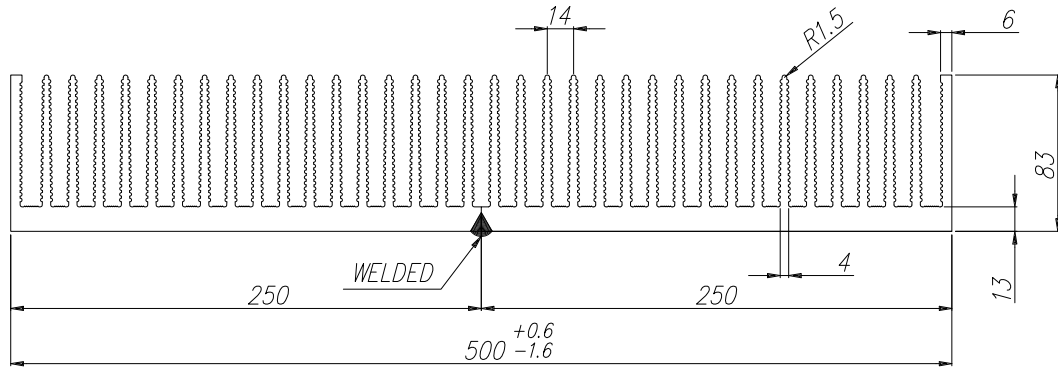

TECNODAL
BOLOGNA - ITALY

B

K550

Peso Kg/m
Weight Kg/m 48.90

Rt °C/W 0.12

Lung. campione mm
Sample length mm 150

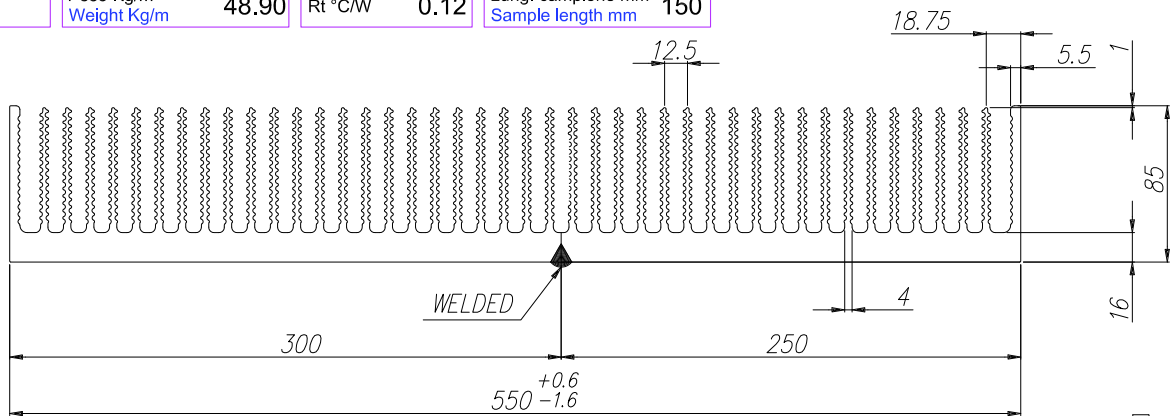

TECNODAL
BOLOGNA - ITALY

C

K600

Peso Kg/m
Weight Kg/m 53.24

Rt °C/W 0.10

Lung. campione mm
Sample length mm 150

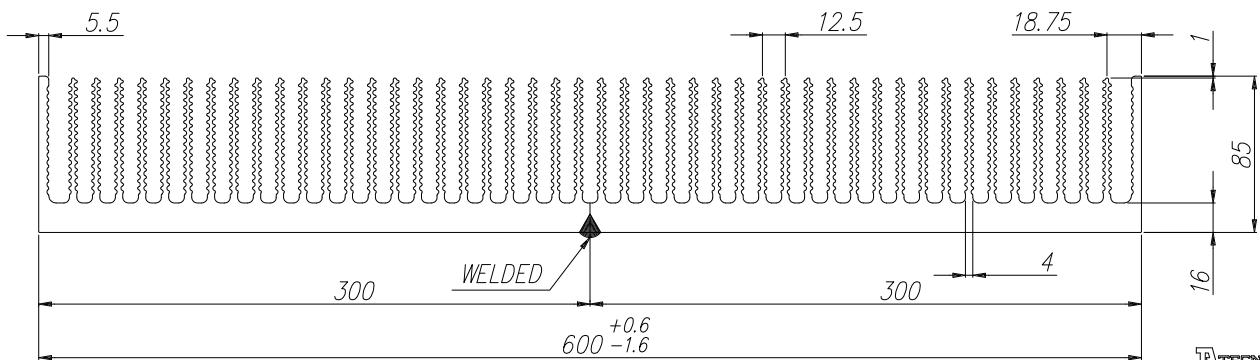

TECNODAL
BOLOGNA - ITALY

D

K650

Peso Kg/m
Weight Kg/m 57.65

Rt °C/W 0.098

Lung. campione mm
Sample length mm 150

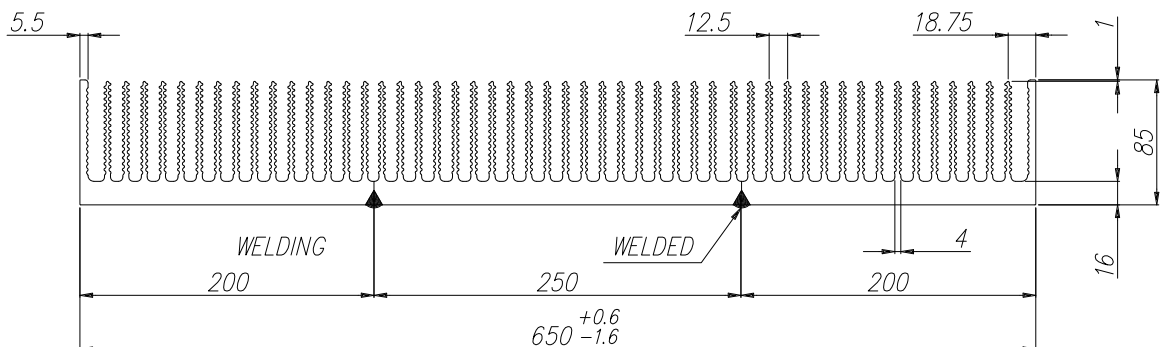

TECNODAL
BOLOGNA - ITALY

Up on request

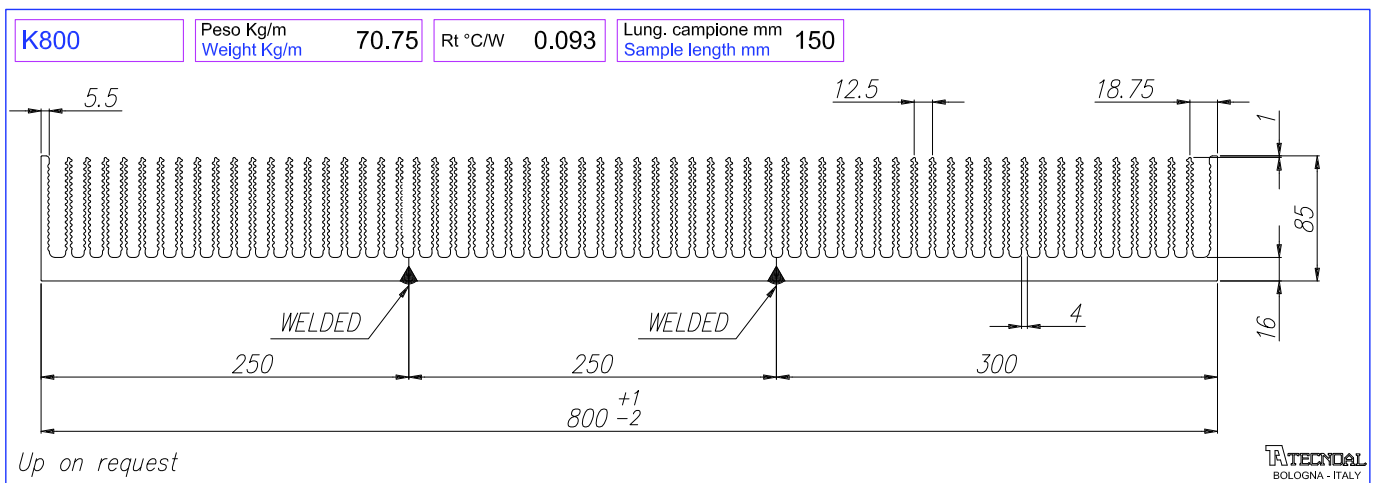
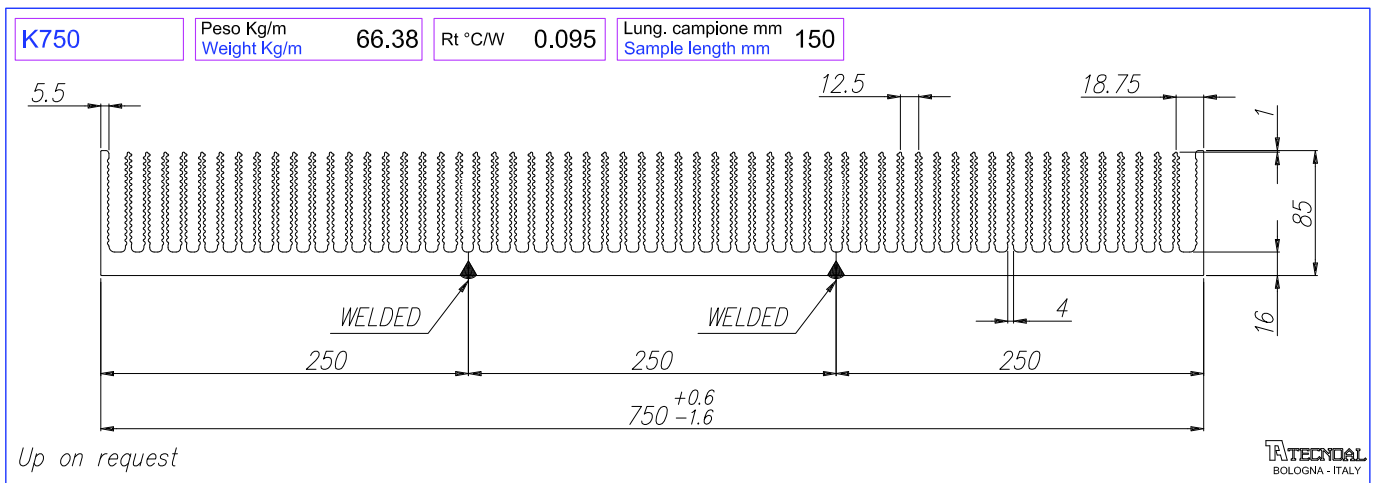
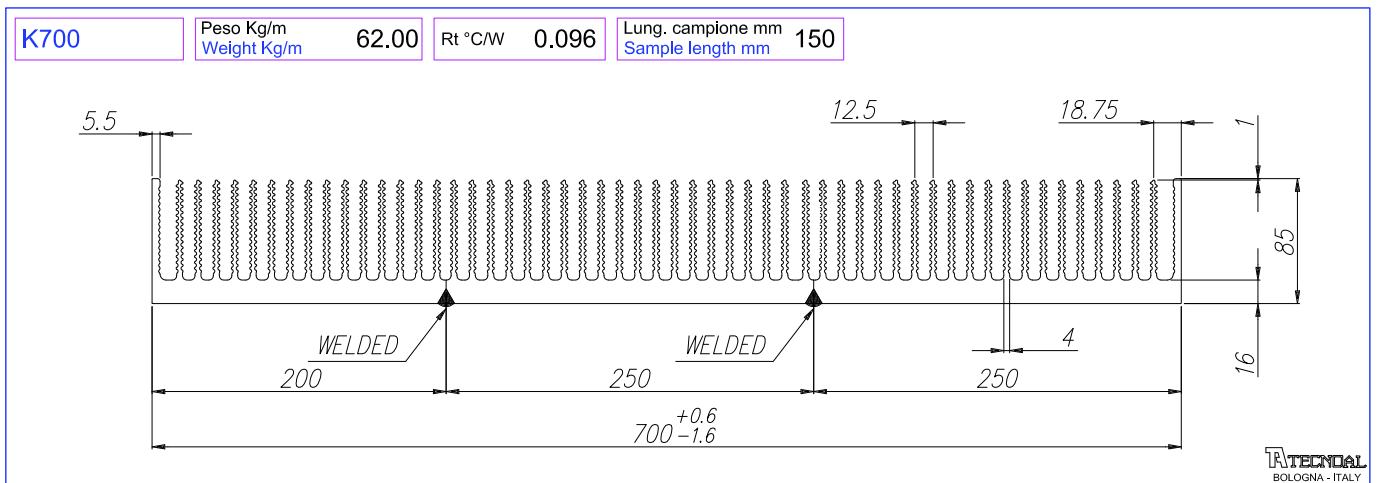
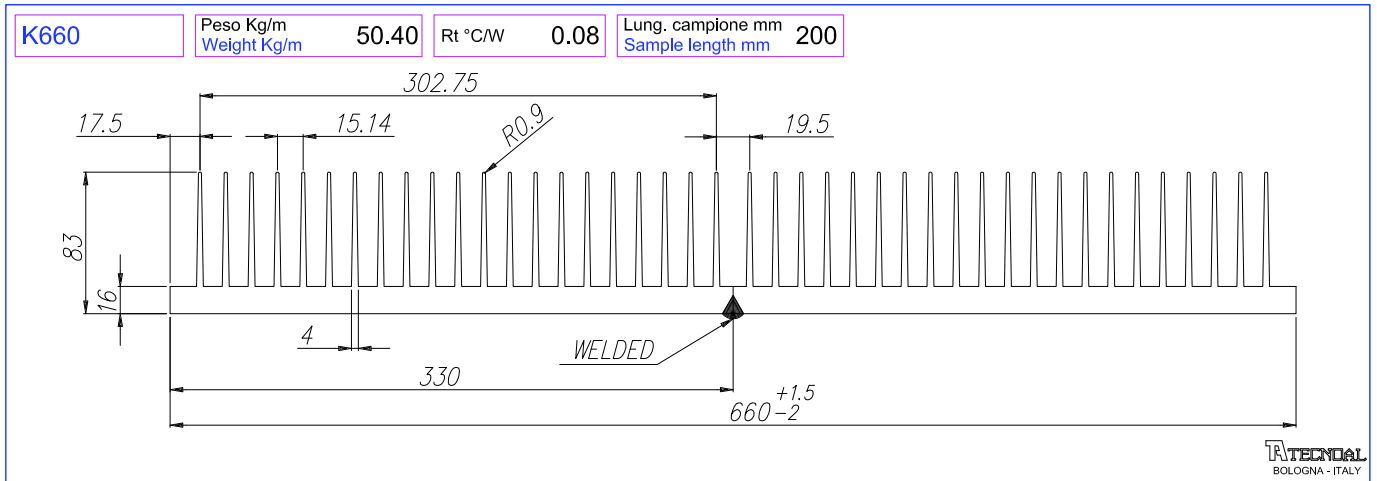



A

K850	Peso Kg/m Weight Kg/m	75.15	Rt °C/W	0.090	Lung. campione mm Sample length mm	150
-------------	--------------------------	--------------	---------	--------------	---------------------------------------	------------

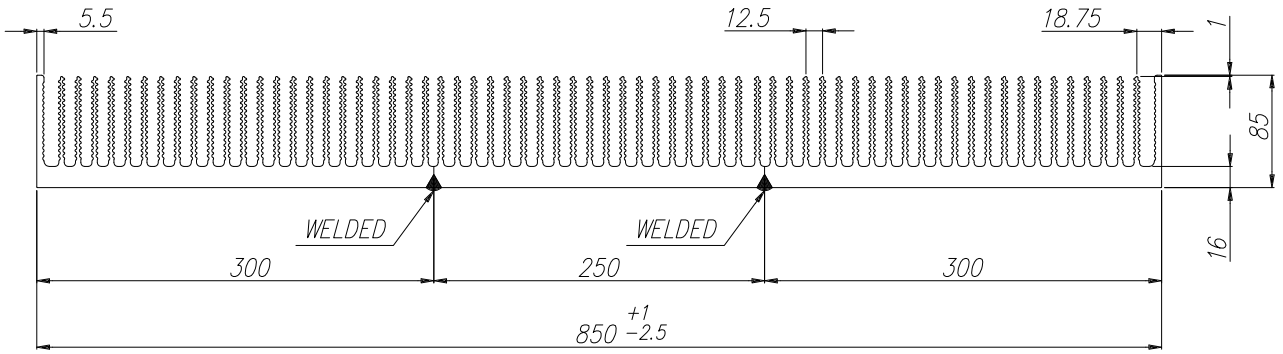

Up on request



B

K900	Peso Kg/m Weight Kg/m	79.50	Rt °C/W	0.086	Lung. campione mm Sample length mm	150
-------------	--------------------------	--------------	---------	--------------	---------------------------------------	------------

